

日本語

SVENSKA

ITALIANO

ESPAÑOL

NEDERLANDS

DEUTSCH

FRANÇAIS

ENGLISH



marantz[®] Wireless Dock for iPod
IS301



User Guide



The lightning flash with arrowhead symbol within an equilateral triangle is intended to alert the user to the presence of uninsulated "dangerous voltage" within the product's enclosure that may be of sufficient magnitude to constitute a risk of electric shock to persons.



The exclamation point within an equilateral triangle is intended to alert the user to the presence of important operating and maintenance (servicing) instructions in the literature accompanying the product.

WARNING

**TO REDUCE THE RISK OF FIRE OR ELECTRIC SHOCK,
DO NOT EXPOSE THIS APPLIANCE TO RAIN OR MOISTURE.**

NOTE:

This equipment has been tested and found to comply with the limits for a Class B digital device, pursuant to Part 15 of the FCC Rules. These limits are designed to provide reasonable protection against harmful interference in a residential installation. This equipment generates, uses and can radiate radio frequency energy and, if not installed and used in accordance with the instructions, may cause harmful interference to radio communications. However, there is no guarantee that interference will not occur in a particular installation. If this equipment does cause harmful interference to radio or television reception, which can be determined by turning the equipment off and on, the user is encouraged to try to correct the interference by one or more of the following measures:

Reorient or relocate the receiving antenna. Increase the separation between the equipment and receiver. Connect the equipment into an outlet on a circuit different from that to which the receiver is connected. Consult the dealer or an experienced radio/TV technician for help.

NOTE:

Changes or modifications may cause this unit to fail to comply with Part 15 of the FCC Rules and may void the user's authority to operate the equipment.

This Class B digital apparatus complies with Canadian ICES-003.

Cet appareil numérique de la Classe B est conforme a la norme NMB-003 du Canada.

IMPORTANT SAFETY INSTRUCTIONS

READ BEFORE OPERATING EQUIPMENT

This product was designed and manufactured to meet strict quality and safety standards.

There are, however, some installation and operation precautions which you should be particularly aware of.

1. Read these instructions.
2. Keep these instructions.
3. Heed all warnings.
4. Follow all instructions.
5. Do not use this apparatus near water.
6. Clean only with dry cloth.
7. Do not block any ventilation openings. Install in accordance with the manufacture's instructions.
8. Do not install near any heat sources such as radiators, heat registers, stoves, or other apparatus (including amplifiers) that produce heat.
9. Do not defeat the safety purpose of the polarized or grounding-type plug. A polarized plug has two blades with one wider than the other. A grounding type plug has two blades and a third grounding prong. The wide blade or the third prong are provided for your safety. If the provided plug does not fit into your outlet, consult an electrician for replacement of the obsolete outlet.
10. Protect the power cord from being walked on or pinched particularly at plugs, convenience receptacles, and the point where they exit from the apparatus.
11. Only use attachments/accessories specified by the manufacturer.
12. Use only with the cart, stand, tripod, bracket, or table specified by the manufacturer, or sold with the apparatus. When a cart is used, use caution when moving the cart/apparatus combination to avoid injury from tip-over.
13. Unplug this apparatus during lightning storms or when unused for long periods of time.
14. Refer all servicing to qualified service personnel. Servicing is required when the apparatus has been damaged in any way, such as power-supply cord or plug is damaged, liquid has been spilled or objects have fallen into the apparatus, the apparatus has been exposed to rain or moisture, does not operate normally, or has been dropped.



ENGLISH

WARRANTY

For warranty information, contact your local Marantz distributor.

RETAIN YOUR PURCHASE RECEIPT

Your purchase receipt is your permanent record of a valuable purchase. It should be kept in a safe place to be referred to as necessary for insurance purposes or when corresponding with Marantz.

IMPORTANT

When seeking warranty service, it is the responsibility of the consumer to establish proof and date of purchase. Your purchase receipt or invoice is adequate for such proof.

FOR U.K. ONLY

This undertaking is in addition to a consumer's statutory rights and does not affect those rights in any way.

FRANÇAIS

GARANTIE

Pour des informations sur la garantie, contacter le distributeur local Marantz.

CONSERVER L'ATTESTATION D'ACHAT

L'attestation d'achat est la preuve permanente d'un achat de valeur. La conserver en lieu sûr pour s'y reporter aux fins d'obtention d'une couverture d'assurance ou dans le cadre de correspondances avec Marantz.

IMPORTANT

Pour l'obtention d'un service couvert par la garantie, il incombe au client d'établir la preuve de l'achat et d'en corroborer la date. Le reçu ou la facture constituent des preuves suffisantes.

DEUTSCH

GARANTIE

Bei Garantiefragen wenden Sie sich bitte an Ihren Marantz-Händler.

HEBEN SIE IHRE QUITTING GUT AUF

Die Quittung dient Ihnen als bleibende Unterlage für Ihren wertvollen Einkauf. Das Aufbewahren der Quittung ist wichtig, da die darin enthaltenen Angaben für Versicherungszwecke oder bei Korrespondenz mit Marantz angeführt werden müssen.

WICHTIG!

Bei Garantiefragen muß der Kunde eine Kaufunterlage mit Kaufdatum vorlegen. Ihren Quittung oder Rechnung ist als Unterlage ausreichend.

NEDERLANDS

GARANTIE

Voor inlichtingen omtrent garantie dient u zich tot uw plaatselijke Marantz.

UW KWITANTIE, KASSABON E.D. BEWAREN

Uw kwitantie, kassabon e.d. vormen uw bewijs van aankoop van een waardevol artikel en dienen op een veilige plaats bewaard te worden voor evt. verwijzing bijv. in verband met verzekering of bij correspondentie met Marantz.

BELANGRIJK

Bij een evt. beroep op de garantie is het de verantwoordelijkheid van de consument een gedateerd bewijs van aankoop te tonen. Uw kassabon of factuur zijn voldoende bewijs.

ESPAÑOL

GARANTIA

Para obtener información acerca de la garantía póngase en contacto con su distribuidor Marantz.

GUARDE SU RECIBO DE COMPRA

Su recibo de compra es su prueba permanente de haber adquirido un aparato de valor. Este recibo deberá guardarlo en un lugar seguro y utilizarlo como referencia cuando tenga que hacer uso del seguro o se ponga en contacto con Marantz.

IMPORTANTE

Cuando solicite el servicio otorgado por la garantía el usuario tiene la responsabilidad de demostrar cuándo efectuó la compra. En este caso, su recibo de compra será la prueba apropiada.

ITALIANO

GARANZIA

L'apparecchio è coperto da una garanzia di buon funzionamento della durata di un anno, o del periodo previsto dalla legge, a partire dalla data di acquisto comprovata da un documento attestante il nominativo del Rivenditore e la data di vendita. La garanzia sarà prestata con la sostituzione o la riparazione gratuita delle parti difettose.

Non sono coperti da garanzia difetti derivanti da uso improprio, errata installazione, manutenzione effettuata da personale non autorizzato o, comunque, da circostanze che non possano riferirsi a difetti di funzionamento dell'apparecchio. Sono inoltre esclusi dalla garanzia gli interventi inerenti l'installazione e l'allacciamento agli impianti di alimentazione.

Gli apparecchi verranno riparati presso i nostri Centri di Assistenza Autorizzati. Le spese ed i rischi di trasporto sono a carico del cliente.

La casa costruttrice declina ogni responsabilità per danni diretti o indiretti provocati dalla inosservanza delle prescrizioni di installazione, uso e manutenzione dettate nel presente manuale o per guasti dovuti ad uso continuato a fini professionali.

SVENSKA

GARANTI

För information om garantin, kontakta Marantz lokalt.

SPAR KVITTOT

Kvittot är ett inköpsbevis på en värdefull vara. Det skall förvaras säkert och hänvisas till vid försäkringsfall eller vid korrespondens med Marantz.

VIKTIGT

Fö att garantin skall gälla är det kundens sak att framställa bevis och datum om köpet. Kvitto eller faktura är tillräckligt bevis för detta.

English

WARNINGS

- Do not expose the equipment to rain, moisture, dripping or splashing.
- Do not handle the AC adaptor with wet hands.
- Do not cover the ventilation with any items such as tablecloths, newspapers, curtains, etc.
- No naked flame sources, such as lighted candles, should be placed on the equipment.
- When disposing of used batteries, please comply with governmental regulations or environmental public instruction's rules that apply in your country or area.
- Make a space of about 0.1 meter around the unit.
- No objects filled with liquids, such as vases, shall be placed on the equipment.
- When the switch is in the OFF position, the equipment is not completely switched off from MAINS.
- The equipment shall be installed near the power supply so that the power supply is easily accessible.
- Do not expose the unit and batteries to excessive heat such as direct sunlight, fire or the like.

Français

AVERTISSEMENTS

- Ne pas exposer l'appareil à la pluie, à l'humidité, à l'égouttement ou aux éclaboussures.
- Ne pas manipuler l'adaptateur secteur avec les mains humides.
- Ne pas recouvrir les orifices de ventilation avec un objet quelconque comme une nappe, un journal, un rideau, etc.
- Ne placer aucune source de flamme nue, comme une bougie allumée, sur l'appareil.
- Pour mettre au rebut les piles usées, respecter les lois gouvernementales ou les règlements officiels concernant l'environnement qui s'appliquent à votre pays ou région.
- Veiller à ce qu'aucun objet ne soit à moins de 0,1 mètre des côtés de l'appareil.
- Aucun objet rempli de liquide, un vase par exemple, ne doit être placé sur l'appareil.
- Lorsque l'interrupteur est sur la position OFF, l'appareil n'est pas complètement déconnecté du SECTEUR (MAINS).
- L'appareil sera installé près de la source d'alimentation, de sorte que cette dernière soit facilement accessible.
- N'exposez pas l'appareil et les piles à une chaleur excessive, comme par exemple aux rayons directs du soleil, au feu, etc.

Deutsch

WARNHINWEISE

- Das Gerät nicht Regen, Feuchtigkeit, Tropf- oder Spritzwasser aussetzen.
- Berühren Sie den Netzadapter nicht mit nassen Händen.
- Decken Sie die Lüftungsöffnungen nicht mit einem Tischtuch, einer Zeitung, einem Vorhang usw. ab.
- Es dürfen keine Gegenstände mit offener Flamme, wie etwa brennende Kerzen, auf dem Gerät aufgestellt werden.
- Beachten Sie bei der Entsorgung der verbrauchten Batterien alle geltenden lokalen und überregionalen Regelungen.
- Auf allen Geräteseiten muß ein Zwischenraum von ungefähr 0,1 meter vorhanden sein.
- Auf das Gerät dürfen keine mit Flüssigkeiten gefüllte Behälter, wie etwa eine Vase, gestellt werden.
- Wenn der Schalter ausgeschaltet ist (OFF-Position), ist das Gerät nicht vollständig vom Stromnetz (MAINS) abgetrennt.
- Das Gerät sollte in der Nähe einer Netzsteckdose aufgestellt werden, damit es leicht an das Stromnetz angeschlossen werden kann.
- Setzen Sie das Gerät und die Batterien keiner übermäßigen Wärme aus, z.B. durch Aufstellung in direkter Sonneneinstrahlung, in der Nähe eines offenen Feuers usw.

Nederlands

WAARSCHUWINGEN

- Stel het apparaat niet bloot aan regen, vocht, druppels of spetters.
- Raak de wisselstroomadapter niet aan met natte handen.
- Bedek de ventilatieopeningen niet met enige voorwerpen, zoals tafelkleden, kranten, gordijnen, enz.
- Plaats geen brandende voorwerpen, zoals kaarsen, op het apparaat.
- Volg bij het weggooiën van verbruikte batterijen de overheidswetgeving of milieuvoorschriften op die van kracht zijn in het land of de regio waarin u zich bevindt.
- Zorg dat er 0,1 meter vrije ruimte rond het toestel is.
- Plaats geen voorwerpen met een vloeistof erin, zoals een bloemenvaas, op het apparaat.
- Als de schakelaar op OFF staat, is het apparaat niet volledig losgekoppeld van de netspanning (MAINS).
- De apparatuur wordt in de buurt van het stopcontact geïnstalleerd, zodat dit altijd gemakkelijk toegankelijk is.
- Stel het apparaat en de batterijen niet bloot aan grote warmte, zoals direct zonlicht, vuur en dergelijke.

Español

ADVERTENCIAS

- No exponga el equipo a la lluvia, la humedad, goteos o salpicaduras.
- No toque el adaptador de CA con las manos húmedas.
- No cubra la ventilación con objetos como manteles, periódicos, cortinas, etc.
- No deben colocarse sobre el equipo elementos con fuego, por ejemplo velas encendidas.
- Cuando se eliminen baterías usadas, deben cumplirse las reglamentaciones oficiales o las normas de protección medioambiental aplicables en su país o en su zona.
- Deje un espacio de unos 0,1 metro alrededor de la unidad.
- No se deben colocar sobre el aparato recipientes que contengan líquidos, como por ejemplo jarrones.
- Cuando el interruptor está en la posición OFF, el equipo no está completamente desconectado de la alimentación MAINS.
- El equipo se instalará cerca de la fuente de alimentación de manera que resulte fácil acceder a ella.
- No exponga la unidad y las pilas a un calor excesivo, tal como el derivado de la luz directa del sol, el fuego, o alguna fuente térmica similar.

Italiano

AVVERTENZE

- Non esporre l'apparecchio alla pioggia, all'umidità, al gocciolamento o agli spruzzi.
- Non toccare l'adattatore CA con le mani bagnate.
- Non coprire le fessure di ventilazione con tovaglie, giornali, tende od oggetti analoghi.
- Non posare sull'apparecchio sorgenti di fiamme scoperte quali candele accese.
- Smaltire le pile usate in conformità alle norme governative o disposizioni ambientali vigenti nel proprio paese o zona.
- Lasciare 0,1 metro liberi tutto intorno l'unità.
- Non mettere sull'apparecchiatura alcun contenitore di liquido, come ad esempio dei vasi.
- Quando l'interruttore è nella posizione OFF, l'apparecchiatura non è completamente scollegata da MAINS.
- L'apparecchio va installato in prossimità della fonte di alimentazione, in modo che quest'ultima sia facilmente accessibile.
- Non esporre l'unità e le batterie a calore eccessivo come la luce diretta del sole, il fuoco o così via.

Svenska







VARNINGAR

- Utsätt inte utrustningen för regn, fukt, droppande vatten eller vattenstänk.
- Hantera inte nätadaptern med våta händer.
- Täck inte för ventilationsöppningarna med några föremål som till exempel bordsdukar, dagstidningar, gardiner e.d.
- Inga föremål med öppen låga, som till exempel tända stearinljus, bör placeras på utrustningen.
- Följ de lagar och miljöskyddsråd som gäller i det land eller område där du bor när du gör dig av med batterier.
- Se till att det finns omkring 0,1 meter fri plats runt omkring enheten.
- Inga objekt som är fyllda med någon vätska, till exempel blomstervaser, bör placeras på apparaten.
- Även om strömbrytaren står i det avstängda läget OFF, så är utrustningen inte helt bortkopplad från det elektriska nätet (MAINS).
- Utrustningen ska vara installerad nära strömuttaget så att strömförsörjningen är lätt att tillgå.
- Utsätt inte enheten och batterierna för kraftig värme, såsom direkt solljus, eld eller liknande.

Marking

In line with CE marking regulations: the CE mark and the class 2 identifier are added to the equipment:



ENGLISH	A NOTE ABOUT RECYCLING <p>This product's packaging materials are recyclable and can be reused. This product and the accessories packed together are the applicable product to the WEEE directive except batteries. Please dispose of any materials in accordance with your local recycling regulations. When discarding the unit, comply with your local rules or regulations. Batteries should never be thrown away or incinerated but disposed of in accordance with your local regulations concerning chemical wastes.</p> 
FRANÇAIS	REMARQUE CONCERNANT LE RECYCLAGE <p>Le matériel d'emballage de cet appareil est recyclable et peut être réutilisé. Cet appareil et les accessoires qui sont emballés avec celui-ci sont conformes, à l'exception des piles, à la directive DEEE (relative aux déchets d'équipements électriques et électroniques). Jetez ce matériel conformément aux réglementations de recyclage locales. Pour mettre l'appareil au rebut, respectez les règles ou réglementations locales. Les piles ne doivent jamais être jetées ou incinérées, mais être mises au rebut conformément aux réglementations locales concernant les déchets chimiques.</p> 
DEUTSCH	RECYCLING-HINWEIS <p>Das Verpackungsmaterial dieses Produkts ist für Recycling geeignet und kann wiederverwendet werden. Dieses Produkt und das in seinem Verpackungskarton enthaltene Zubehör mit Ausnahme der Batterien entsprechen der WEEE-Direktive. Bitte beachten Sie bei der Entsorgung irgendwelcher Materialien die örtlichen Recycling-Bestimmungen. Bei der Entsorgung des Gerätes sind die einschlägigen Umweltschutzaufgaben sorgfältig zu befolgen. Batterien dürfen nicht weggeworfen oder verbrannt werden, sondern müssen gemäß den örtlichen Vorschriften zur Entsorgung von chemischem Abfall entsorgt werden.</p> 
NEDERLANDS	RECYCLING VAN APPARATUUR EN VERPAKKINGSMATERIAAL <p>De verpakking van dit product is geschikt voor recycling. Dit product en de accessoires, als geheel verpakt, zijn het relevante product volgens de WEEE-richtlijn, behalve de batterijen. Gooi materialen bij het afval volgens de gemeentelijke voorschriften voor recycling. Gooi dit apparaat bij het afval volgens de gemeentelijke wetten of voorschriften. Batterijen mogen nooit bij het normale afval en mogen nooit worden verbrand, maar moeten worden weggegooid volgens de gemeentelijke voorschriften voor chemisch afval.</p> 
ESPAÑOL	NOTA SOBRE EL RECICLADO <p>Los materiales de embalaje de este producto son reciclables y pueden ser reutilizados. En este producto y sus accesorios incluidos es aplicable la directiva europea sobre residuos de aparatos eléctricos y electrónicos (RAEE), excepto en lo referente a las pilas. Se ruega eliminar cualquiera de esos materiales de acuerdo con las normas locales de reciclado. Cuando deseche esta unidad, cumpla con las normas o reglamentaciones locales. Las pilas no deben tirarse ni incinerarse, sino que deben eliminarse de acuerdo con las normas locales sobre residuos químicos.</p> 
ITALIANO	NOTA SUL RICICLAGGIO <p>I materiali di imballaggio di questo prodotto sono riciclabili e possono essere riutilizzati. Questo prodotto e gli accessori in dotazione con esso, eccettuate le batterie, rappresentano il prodotto applicabile per la direttiva RAEE (rifiuti di apparecchiature elettriche ed elettroniche). Smaltirli seguendo le proprie normative locali sul riciclaggio. Quando si desidera eliminare l'apparecchio, attenersi alle indicazioni e alle normative locali. Non gettare via le batterie e non bruciarle, ma smaltirle in conformità alle normative locali relative ai rifiuti chimici.</p> 
SVENSKA	OM ÅTERVINNING <p>Den här produktens förpackningsmaterial är återvinningsbart och kan återanvändas. Den här produkten och de med produkten levererade tillbehören, förutom batterierna, överensstämmer med WEEE-direktivet. Kassera allt material i enlighet med lokala miljöföreskrifter. När enheten ska kasseras ska du följa lokala miljöföreskrifter. Batterier får aldrig slängas i hushållsavfall eller brännas. Dom ska hanteras i enlighet med lokala miljöföreskrifter för kemiskt avfall.</p> 

Thank you for purchasing the Marantz IS301 Wireless Dock for iPod.
 This remarkable component has been engineered to provide you with many years of listening enjoyment. Please take a few minutes to read this manual thoroughly before you connect and operate the IS301.
 As there are a number of connection and configuration options, you are encouraged to discuss your own particular system setup with your Marantz authorized dealer.

CONTENTS

FEATURES	1
BEFORE USE	1
CONNECTABLE iPod PRODUCTS	1
CHECKING THE PRODUCT AND ACCESSORIES	2
NAMES AND FUNCTIONS	3
HANDSET (IS301)	3
BASE UNIT (IS301DS)	4
EXTENDER (IS301RX)	5
BASIC OPERATIONS	6
PREPARATION OF THE AC ADAPTOR	6
WIRELESS CONNECTION	6
IS-LINK (WIRED) CONNECTIONS	10
ADVANCED OPERATIONS	12
CONNECTING THE EXTENDER WITH OTHER BLUETOOTH DEVICES	12
MOUNTING ON A WALL	13
USE OF THE REMOTE CONTROLLER (RC001IS)	15
TROUBLESHOOTING	17
OTHERS	17
SPECIFICATIONS	18

FEATURES

- By connecting an iPod and your home audio equipment via this unit, you can play back audio files in the iPod with your audio equipment.
- According to your purposes and environment of use, either wireless connection or wired connection can be selected.
- Thanks to audio wireless transmission technologies using the *Bluetooth*® A2DP profile, the handset and extender can be used via wireless connection.
- Thanks to wireless remote control technologies using the *Bluetooth*® AVRCP Profile, you can remotely control Marantz audio amplifiers and other equipment that supports the *Bluetooth*® AVRCP Profile.
- This unit supports the SCMS-T content protection method for *Bluetooth*®. (IS301RX)
- Video signals can be output from an iPod.
- Thanks to the thickness adjustment knob on the handset, an iPod can be attached to the handset without using a docking adaptor.
- Two methods for installing this unit are available: on the table or on the wall.
- An iPod can be easily attached or detached.
- Recharging of an iPod is possible.

BEFORE USE

CONNECTABLE iPod PRODUCTS

- iPod touch (1st and 2nd generations)
- iPod classic
- iPod nano (1st, 2nd, 3rd, and 4th generations)
- iPod (4th and 5th generations)
- iPod mini

iPod is a trademarks of Apple Inc., registered in the U.S. and other countries.

Notes

- Before use, be sure to update your iPod product to the latest version.
- Visit and acquire the updater for updating your iPod to the latest version from the Web site of Apple Inc.

BEFORE USE

CHECKING THE PRODUCT AND ACCESSORIES

After opening the cover of the packing box, check that the following product and accessories are included.

- Handset (IS301) 1
- Remote controller (RC001IS) 1
- IS-LINK cables (CAT5/LAN straight-type cables) ... 2

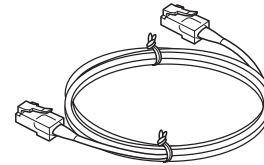
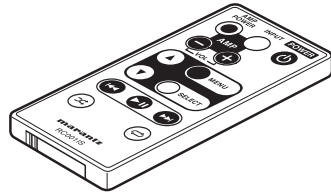
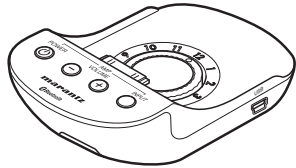

- Base unit (IS301DS) 1
- AC adaptors (for the base unit and extender) .. 2
- AV cable 1
- Remote cable 1
- USB cable 1
- Wall-mounting screws 4

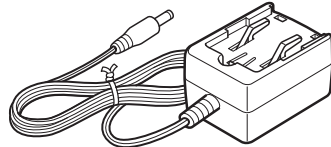
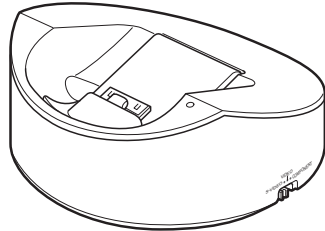

- Extender (IS301RX) 1
- Power plugs for the AC adaptors
 - For the U.S.A./Japan 2
- User Guide 1
- Warranties
 - For Canada 1
 - For the U.S.A. 1

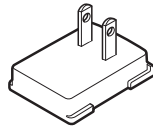
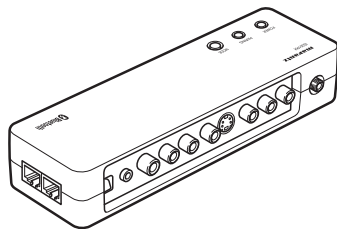

- Antenna for the extender 1
- For Europe 2

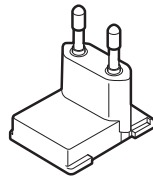
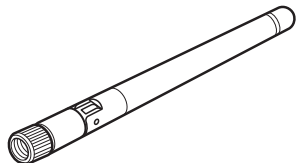

NAMES AND FUNCTIONS

HANDSET (IS301)

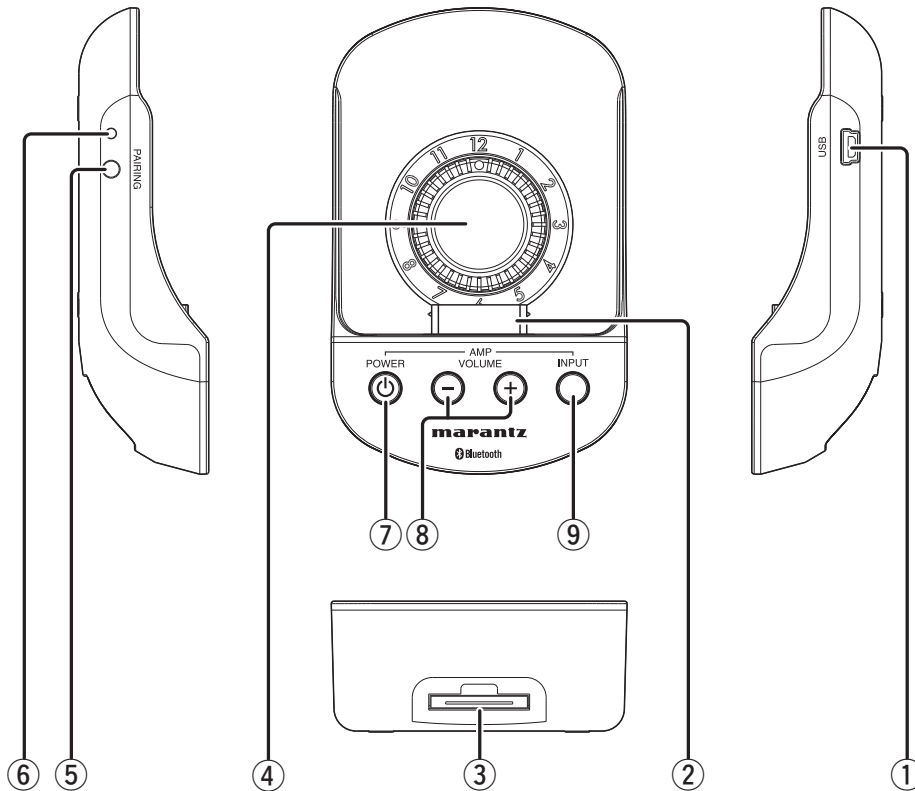

① USB connector

Connect your PC, using the supplied USB cable. Synchronizing the iPod with iTunes is possible with your iPod docked in the handset.

② iPod docking connector

Connect the docking connector of the iPod.

③ Base connector

Connect the Handset connector of the base unit.

④ Thickness adjustment knob

Turn this knob to adjust the thickness, according to the thickness of your iPod product. Inappropriate thickness adjustment may result in damage to the connectors.

For details, see "CONNECTING YOUR IPOD WITH THE HANDSET" (page 8).

⑤ PAIRING button

Use this button to establish Bluetooth connection with the extender.

⑥ PAIRING indicator

This indicates connection status with the extender with lighting/flashing and colors.

⑦ POWER button (AMP control buttons)

This button turns ON/OFF the Marantz amplifier/receiver that is remotely connected with the extender.

⑧ VOL +/- buttons (AMP control buttons)

These buttons increase/decrease the volume of the Marantz amplifier/receiver that is remotely connected with the extender.

⑨ INPUT button (AMP control buttons)

This button switches the input sources of the Marantz amplifier/AV receiver that is remotely connected with the extender. (Some products do not correspond to this function.)

NAMES AND FUNCTIONS

BASE UNIT (IS301DS)

TOP VIEW

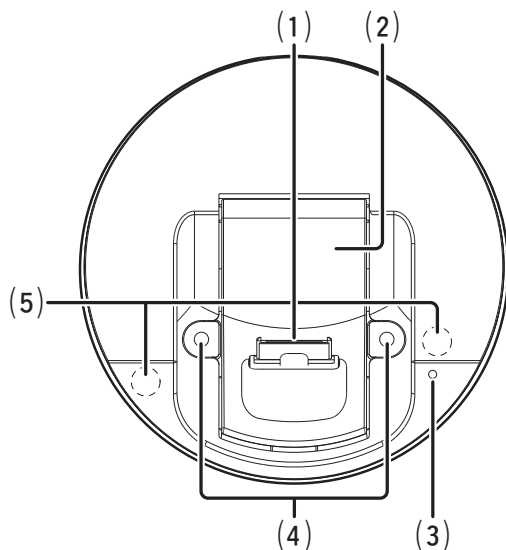

SIDE AND BOTTOM VIEWS

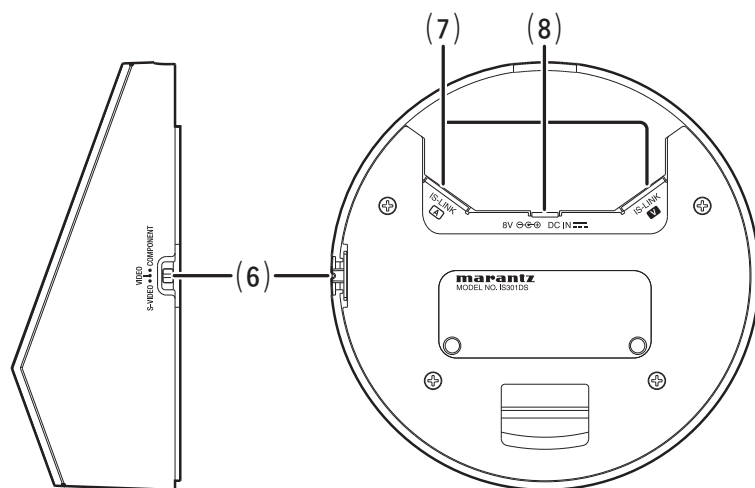

(1) Handset connector

Connect the handset here.

Note

NEVER connect an iPod directly with this connector, because the shape of this connector is different from the docking connector of the iPods.

(2) Handset holder

When the base unit is mounted on a wall, raise this holder. For details, see INSTALLATION PROCEDURES FOR THE BASE UNIT (page 13).

(3) Power indicator

This indicator lights when power is supplied from the AC adaptor or when the base unit is connected with the powered extender via the IS-LINK cable. It flashes when an infrared signal from the remote controller is received.

(4) Holes for wall mounting

Use these holes when mounting the base unit on a wall.

(5) Infrared signal reception window

This is the reception window for infrared signals from the remote controller.

(6) Video selection switch

Select video signals (S-VIDEO/VIDEO/COMPONENT) that are output from the extender. If the Video selection switch is switched during video playback, the output signal may not be switched, depending on the type of iPods being connected. In such a case, go back to the MENU screen then restart video playback.

(7) IS-LINK A/V terminals

Used to connect the base unit and the extender via the supplied IS-LINK cables. Before connection, unplug the power cord then check that the connections to the IS-LINK A and V terminals are properly made.

TRANSMISSION SIGNALS VIA IS-LINK A

- Audio signal
- Remote control signal
- Power

TRANSMISSION SIGNALS VIA IS-LINK V

- Video signal
- External control signal

(8) AC adaptor terminal

Connect the supplied AC adaptor. If the base unit and the extender is connected by the IS-LINK A connection, power will be supplied from the extender. Therefore, it is not required to connect the AC adaptor to the base unit.

EXTENDER (IS301RX)

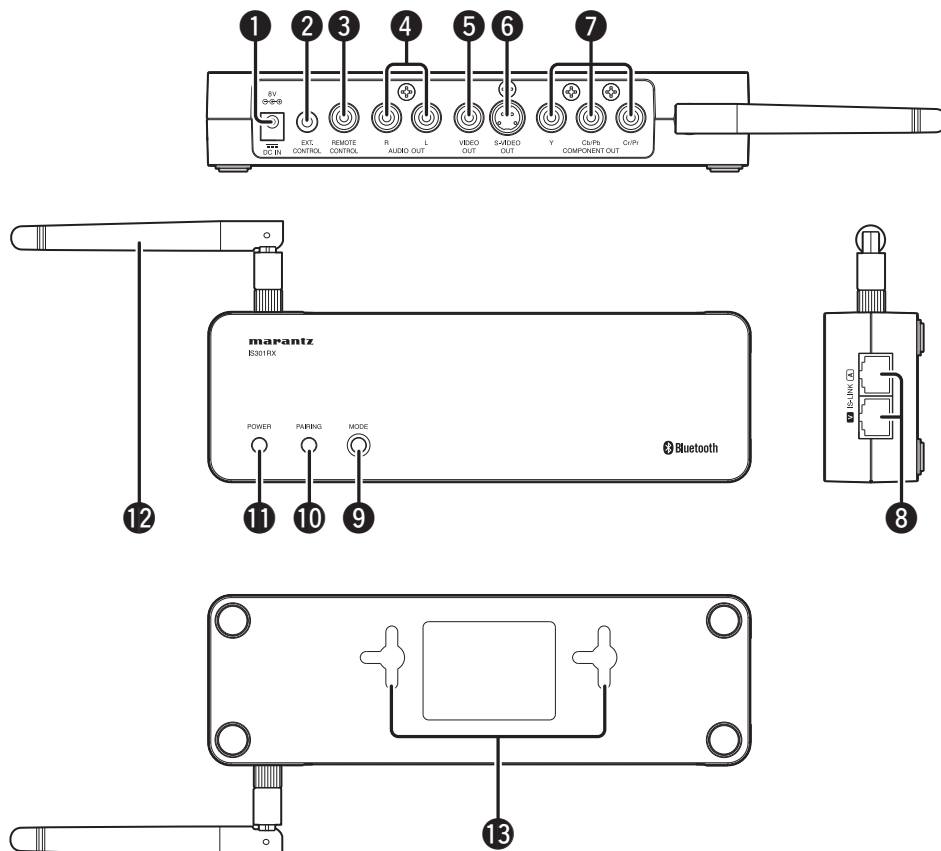

1 AC adaptor terminal

Connect the supplied AC adaptor.

2 EXT. CONTROL terminal

Used to connect an external control system.

3 REMOTE CONTROL terminal

Connect to a Marantz product equipped with a remote control terminal.

4 AUDIO OUT L/R terminals

Connect to the audio input terminals of an amplifier/receiver/TV.

5 VIDEO OUT terminal

Connect to the video input terminal of a receiver/TV.

6 S-VIDEO OUT terminal

Connect to the S-VIDEO input terminal of a receiver/TV.

7 COMPONENT (Y, Cb/Pb, Cr/Pr) VIDEO OUT terminals

Connect to the component video input terminals of a receiver/TV.

8 IS-LINK A/V terminals

Used to connect the base unit and the extender via the supplied IS-LINK cables.
Connect the supplied IS-LINK cables.
Before connection, unplug the power cord then check that the connections to the IS-LINK A and V terminals are properly made.

TRANSMISSION SIGNALS VIA IS-LINK A

- Audio signal
- Remote control signal
- Power

TRANSMISSION SIGNALS VIA IS-LINK V

- Video signal
- External control signal

9 MODE button

Use this button to establish a wireless connection between the handset and extender.

10 PAIRING indicator

This indicates connection status with the handset with lighting/flashing and colors.

11 POWER indicator

This indicator lights when the AC adaptor is connected to the extender.

12 Antenna

This is an antenna for wireless communication.
At shipment, this antenna is packed separately from the extender.
For details on how to mount on the extender, see page 7.

13 Holes for wall mounting

Use these holes when mounting the extender on the wall.

BASIC OPERATIONS

PREPARATION OF THE AC ADAPTOR

POWER PLUG ATTACHMENT PROCEDURES

1. Attach the supplied power plug to the supplied AC adaptor, by sliding the plug in the direction of the arrow.

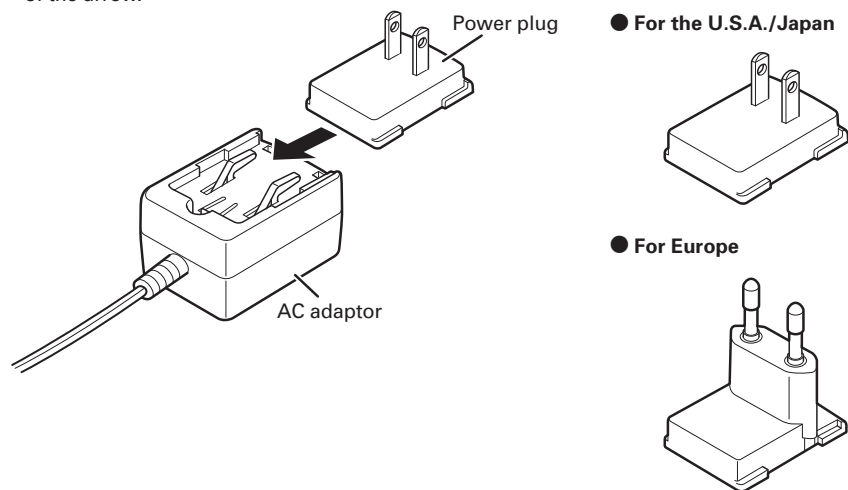

Notes

- NEVER use the power plug with equipment other than the supplied AC adaptor.
- Connect the AC adaptor to the wall outlet nearest its installation position.
- Before plugging/unplugging the cable of the AC adaptor to/from the AC input terminal, make sure that the power cord is unplugged from the wall outlet.
- If an improper power plug is attached to the AC adaptor, detach it by pressing the release button with a pointed object, such as a pen, as shown in the figure below.

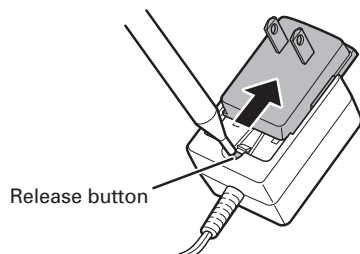

WIRELESS CONNECTION

WHAT ARE AVAILABLE WHEN WIRELESS CONNECTIONS ARE USED

- Audio playback
- Remote operations of a Marantz amplifier or receiver, using the **AMP control** buttons on the handset
- Use of an iPod with the handset detached from the base unit
- Control of a Marantz amplifier, using the supplied remote controller (When the handset is connected with the base unit)

BEFORE CONNECTION

Notes

- If the cable is connected to the IS-LINK terminals, wireless connection will not be enabled.
- If an iPod and the handset are used detached from the base unit, the handset will be powered by the built-in battery of the iPod. This makes it difficult to use them for a long duration. The operable time will differ, depending on the type of iPod products you use.
- What are NOT available when wireless connections are made are as follows:
 - Video playback
 - Use of the base unit as an infrared signal receiver for controlling a Marantz product

ON POWER SUPPLY TO THIS UNIT

A power switch is not provided for this unit. After connecting the AC adaptor to this unit, when the AC adaptor is plugged into a wall outlet, power is supplied to this unit.

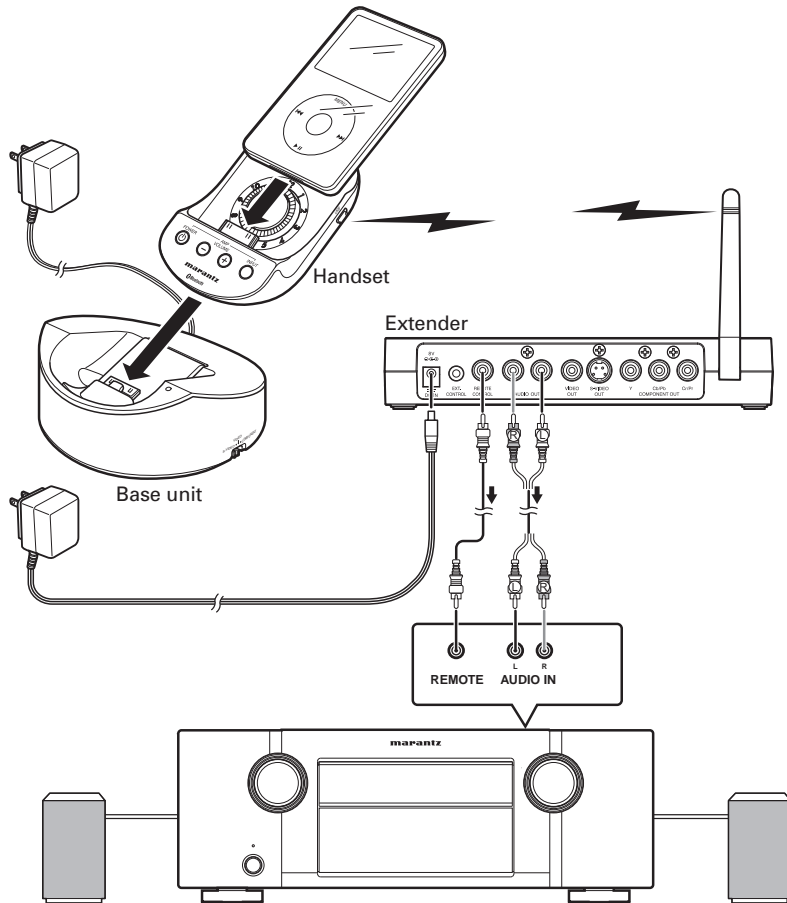

① CONNECTING THE EXTENDER AND AN AMPLIFIER

1. Attach the supplied antenna to the antenna terminal of the extender.
2. Connect the AUDIO OUT terminals of the extender with the line input terminals of an amplifier/receiver, via the supplied AV cable.
3. If you wish to remotely control the connected amplifier/receiver using the Marantz remote control terminals, connect the REMOTE CONTROL terminals of both pieces of equipment via the supplied remote cable. This connection makes it possible to operate the Marantz amplifier/receiver with the **AMP control** buttons (**POWER** button, **VOLUME +/-** buttons, and **INPUT** button) on the handset.
4. Connect the supplied AC adaptor to the AC adaptor terminal of the extender. (For details, see "PREPARATION OF THE AC ADAPTOR". (page 6))

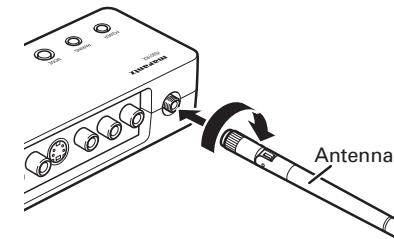

BASIC OPERATIONS

② CONNECTING THE HANDSET TO THE BASE UNIT

1. Attach the handset to the base unit, as shown in the figure below.

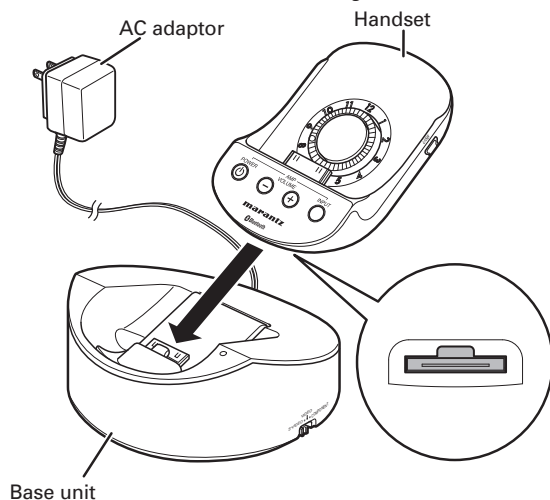

2. Connect the supplied AC adaptor to the AC adaptor terminal of the base unit. (For details, see "PREPARATION OF THE AC ADAPTOR". (page 6))

③ CONNECTING iPod TO THE HANDSET

1. Turn the Thickness adjustment knob of the handset, according to the type of your iPod. For details on the positions of the knob, see the "LIST OF THICKNESS ADJUSTMENT KNOB POSITIONS" table.

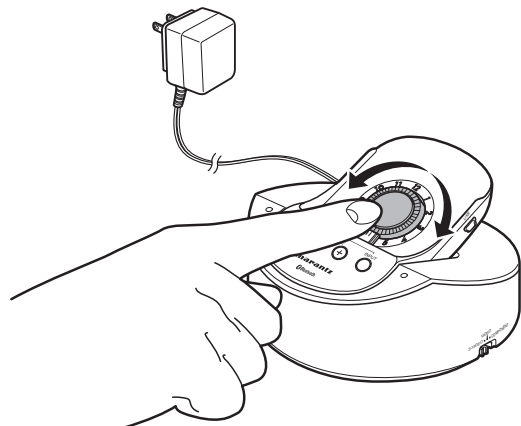

LIST OF THICKNESS ADJUSTMENT KNOB POSITIONS

iPod	Positions of the knob	iPod	Positions of the knob
iPod touch 1G/2G	3	iPod 4G Photo 20GB/30GB	7
iPod classic 160GB	9	iPod 4G Photo 40GB/60GB	12
iPod classic 80GB/120GB	4	iPod 4G 20GB	6
iPod 5G Video 60GB/80GB	9	iPod 4G 40GB	11
iPod 5G Video 30GB	4	iPod nano 1G/2G/3G/4G	1
G in the table stands for Generation of iPod products. Example: iPod 5G (iPod, 5th generation)		iPod mini	7

Notes

- The location of the docking connector on an iPod product varies, according to the generation, type, and capacity of products.

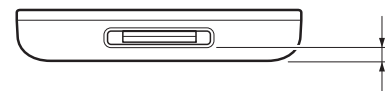

- Before attaching an iPod, be sure to turn the Thickness adjustment knob to an appropriate position. If an iPod is plugged/unplugged without adjusting the thickness to an appropriate position, damage to the connectors may result.

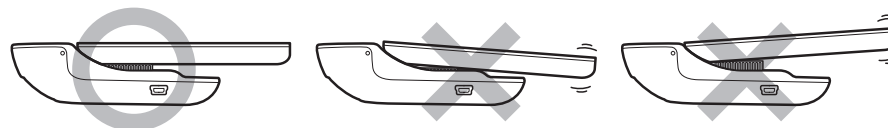

- Securely connect the iPod to the docking connector of the handset.

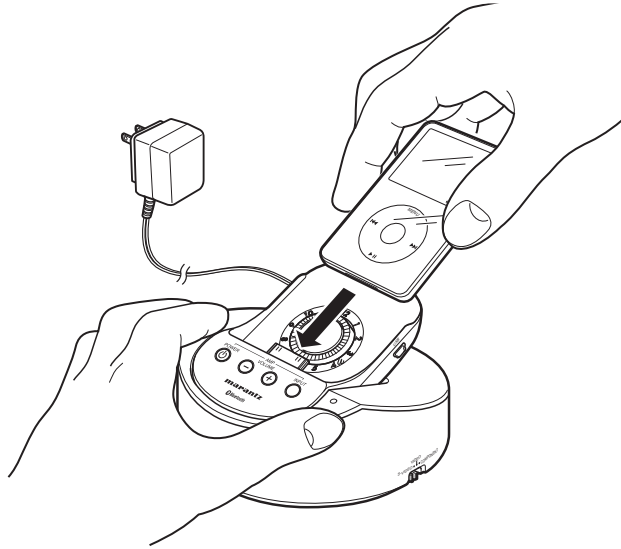

Notes

- When attaching/detaching the iPod to/from the handset, be sure to grip the handset by hand. Improper attaching/detaching of the iPod may damage the connectors.
- When attaching/detaching the iPod to/from the handset, be sure NOT to twist the iPod, as this may damage the connectors.
- Be careful NOT to tilt the iPod forward during use, as this may damage the connectors.

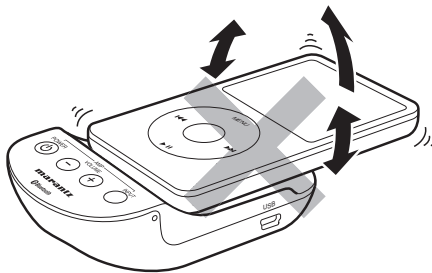

- NEVER insert the iPod into the handset with its protective case attached. Doing so may result in poor connection or damage to the connectors.
- Do not use other accessories, such as an FM transmitter or microphone, with the handset. This may result in a malfunction.
- Marantz accepts no responsibility whatsoever for any loss or damage of iPod data resulting from the use of an iPod product connected with this unit.

④ MAKING WIRELESS CONNECTION BETWEEN THE HANDSET AND EXTENDER

For wireless connection between the handset and extender, pairing is required for mutual authentication and registration. Perform pairing, according to the procedures shown below.

PAIRING PROCEDURES

- Attach the handset to the base unit.
- Locate the extender near the base unit and connect the AC adaptors to each of them.
- Press and release the **PAIRING** button of the handset and the **MODE** button of the extender once. The **PAIRING** indicator will light in red (connection not established).

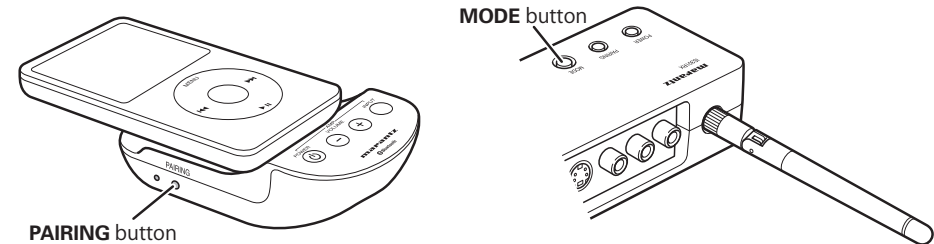

- Press and hold the **PAIRING** button of the handset and the **MODE** button of the extender for 5 seconds or more until the **PAIRING** indicator starts alternate flashing in blue and red at intervals of 0.5 second. The handset and extender will search for each other's pairing device.
- After searching and pairing are completed, the color of the flashing **PAIRING** indicator at intervals of 0.5 second will change to blue. The unit will automatically start preparing for wireless audio playback.

When the **PAIRING** indicator starts flashing in blue at intervals of 5 seconds, preparation for audio playback is completed.

Play back the iPod.

Notes

- Even if wireless connection is interrupted for some reason, such as radio wave interference or power failure, reconnection will automatically be performed.
- If reconnection is not possible, the **PAIRING** indicator will light in red.

In such a case, press the **PAIRING** button of the handset twice to disconnect then press the same button again so that the **PAIRING** indicator lights in red.

Then press the **PAIRING** button once again. The **PAIRING** indicator will start flashing in blue at intervals of 0.5 second to start preparing for reconnection. When the **PAIRING** indicator starts flashing in blue at intervals of 5 seconds, preparation for reconnection is completed.

IN A CASE WHERE THE IPOD AND HANDSET ARE USED DETACHED FROM THE BASE UNIT

Depending on the type of iPod, the handset may not enter Wireless mode when the iPod is started. In such a case, detach the iPod from the handset with the iPod's power on then reconnect it to the handset.

BASIC OPERATIONS

IS-LINK (WIRED) CONNECTIONS

WHAT ARE AVAILABLE WHEN IS-LINK CONNECTIONS ARE USED

- Audio and video playback
- Remote operations of a Marantz amplifier or receiver, using the **AMP control** buttons on the handset
- Remote control of a Marantz amplifier, using the supplied remote controller
- Use of the base unit as an infrared signal receiver for controlling a Marantz product

BEFORE CONNECTION

Notes

- What are NOT available when IS-LINK connections are made are as follows:
 - Video playback of an iPod when the iPod and the handset are detached from the base unit
- During IS-LINK connection, power is supplied to the base unit from the extender. Therefore, it is not necessary to connect the AC adaptor to the base unit.
- Three types of video signals are output from the extender. Set the Video selection switch of the base unit according to the video output signal to be used.
- If the Video selection switch is switched during video playback, the output signal may not be switched, depending on the type of iPods being connected. In such a case, go back to the MENU screen then restart video playback.
- Some iPods do not support component video output.

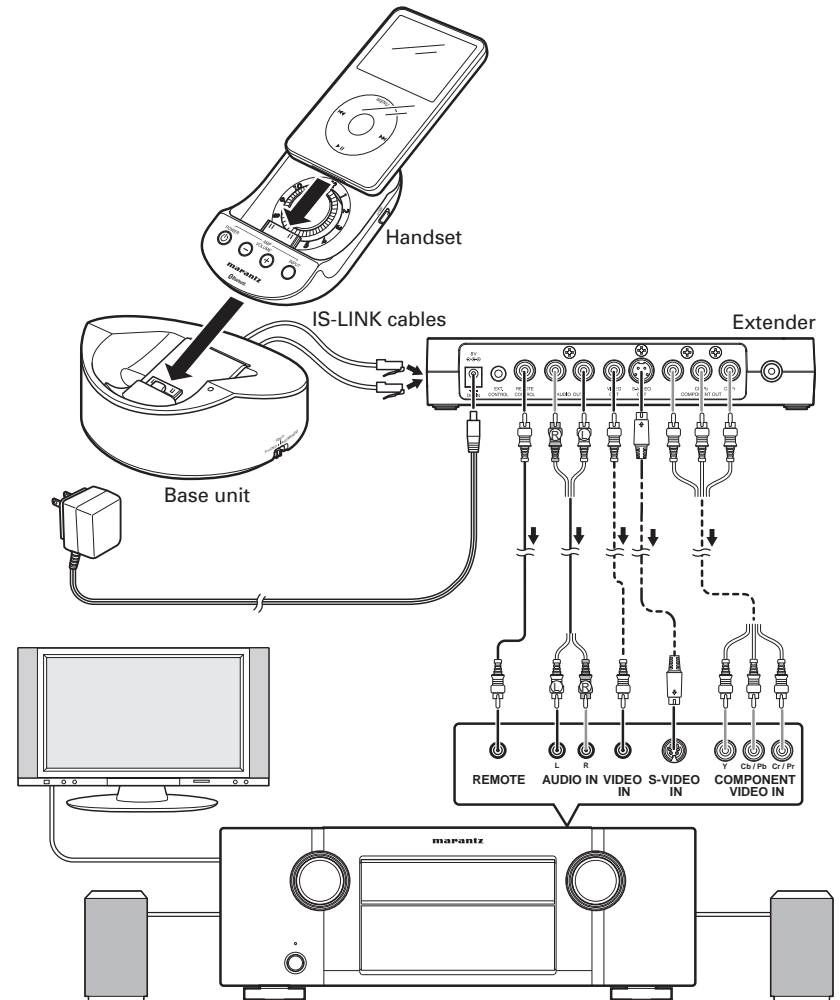
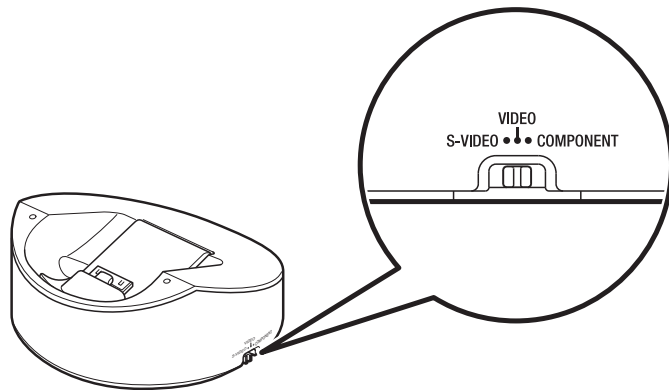

NAMES AND FUNCTIONS
 BASIC OPERATIONS
 ADVANCED OPERATIONS
 TROUBLESHOOTING
 OTHERS

① CONNECTING THE EXTENDER AND AN AMPLIFIER

1. Connect the AUDIO OUT terminals of the extender with the line input terminals of an amplifier/receiver, via the supplied AV cable.
2. Connect the video input terminal of an amplifier/receiver/TV to one of the VIDEO OUT terminals (VIDEO/S-VIDEO/COMPONENT) of the extender, using an appropriate video cable. The S-VIDEO and component video cables are not supplied with this unit. Use a commercially available video cable.

Note

NEVER connect different video cables simultaneously, as this may result in disturbed video signals or a failure.

3. If you wish to remotely control the connected equipment using the Marantz REMOTE CONTROL terminals, connect the REMOTE CONTROL terminals of the connected equipment and the extender with the supplied remote cable.

② CONNECTING THE BASE UNIT AND EXTENDER WITH IS-LINK

1. Connect the base unit and extender with two supplied IS-LINK cables.

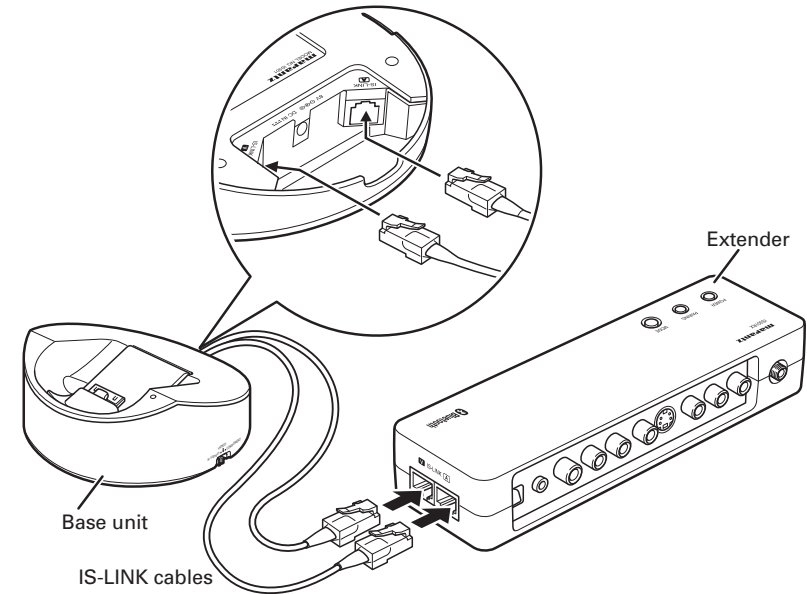

2. Connect the supplied AC adaptor to the AC adaptor terminal of the extender. (For details on preparation of the AC adaptor, see page 6.)

③ CONNECTING THE HANDSET TO THE BASE UNIT

For details on connection, see page 8.

- During IS-LINK connection, power is supplied to the base unit from the extender. Therefore, it is not necessary to connect the AC adaptor to the base unit.

④ CONNECTING AN iPod TO THE HANDSET

For details on connection, see page 8.

ADVANCED OPERATIONS

CONNECTING THE EXTENDER WITH OTHER BLUETOOTH DEVICES

The extender can be connected with other Bluetooth devices with the A2DP profile.

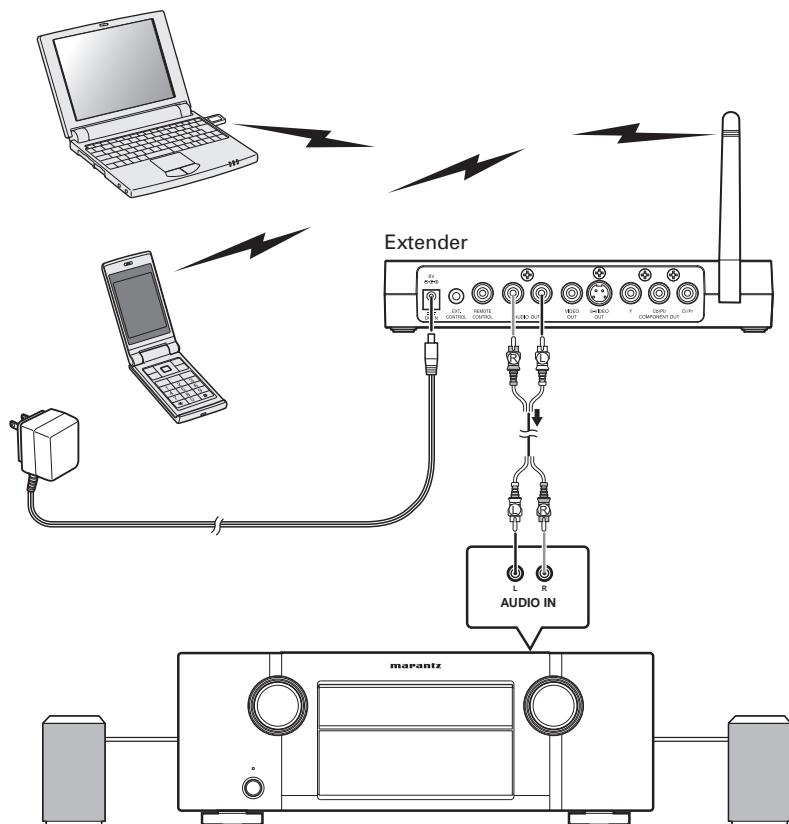

1. When the handset and extender are connected wirelessly, press the **PAIRING** button of the handset. The **PAIRING** indicator will light in red, and wireless communication on the handset side will stop. Let the handset for 10 seconds.
2. Locate other Bluetooth device near the extender.
3. Press the **MODE** button of the extender once. The **PAIRING** indicator will light in red. Refer to the operation manual of your Bluetooth device for pairing procedures of the connected Bluetooth device.
4. Hold the **MODE** button pressed for 5 seconds or more until the **PAIRING** indicator starts alternate flashing in blue and red at intervals of 0.5 second. The unit will search for a device for pairing.
5. After a device to be paired is found, the color of the flashing **PAIRING** indicator at intervals of 0.5 second will change to blue. The unit will automatically start preparing for wireless audio playback. If passcode input is requested on the other Bluetooth device, enter "0000".
6. After connection with the A2DP/AVRCP profiles is established, the **PAIRING** indicator starts flashing in blue at intervals of 5 seconds, and preparation for playback is completed.

Notes

- Once pairing is completed, further pairing operation is not required for the same devices from the next Bluetooth communication.
- Up to 8 Bluetooth devices that have A2DP/AVRCP profiles can be paired with this unit.
- If the number of paired devices exceeds 8, each time a new device is paired, the already paired devices are cleared from the oldest one.
- Connection of the handset with other Bluetooth devices is possible in the same way as with the handset.
- Bluetooth and its logo are trademarks of Bluetooth SIG, Inc. and Marantz uses them based on the appropriate license.
- Connection with all existing Bluetooth devices is not guaranteed.

MOUNTING ON A WALL

This unit can be mounted on a wall. Read the precautions described below and carefully install the unit. For safety, it is recommended to delegate mounting to a professional contractor.

NOTES ON INSTALLATION LOCATION

- Before installation, check the material and construction compatibilities of the installation location. If they are not assured, the unit may fall, which may result in personal injury.
- NEVER mount the unit in a location subject to lot of vibration, shock, or strong force. Doing so may cause a fall or damage of the unit and may result in personal injury.
- Before installation, make sure that there is no electrical wiring nor piping inside the wall.

PRECAUTIONS ON INSTALLATION

- NEVER modify the unit or use it in an inappropriate way. Dropping the unit may result in personal injury.
- The supplied wall-mounting screws are for wooden walls. If the unit is to be mounted on a wall other than wooden walls, procure commercially available screws suitable for the structure and materials of the wall.
- Secure the screws tightly when mounting the base unit. Loose screws may cause an accident, such as falling of the unit. NEVER leave the screws not securely tightened.
- NEVER mount the unit so that it will protrude away from an exterior corner of the wall. Doing so may lead to personal injury, because a person or object may bump into the unit.
- Marantz accepts no responsibility whatsoever for any accident or damage resulting from improper mounting or handling.
- When mounting, be careful not to pinch your fingers or hands.
- Make sure that the two screws are securely tightened in the holes for wall mounting of the extender.

INSTALLATION PROCEDURES FOR THE BASE UNIT

1. Remove the handset from the base unit.
2. Push the stopper holder from through the hole on the bottom of the base unit.

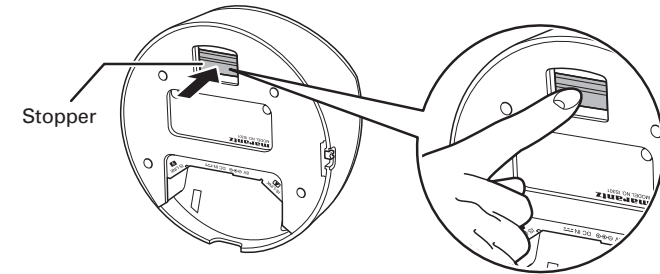

3. With the handset holder raised, push the stopper down so that it clicks and locks in place.

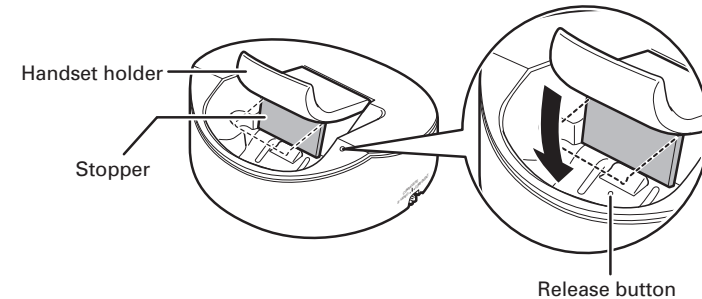

4. Connect the cables.

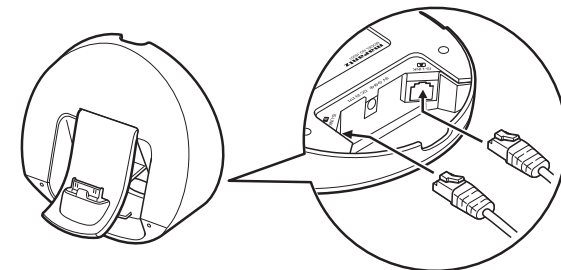

ADVANCED OPERATIONS

- Secure the base unit on the wall, by tightening the screws of the size shown in the figure below, using a screwdriver, through the holes for wall mounting of the base unit.

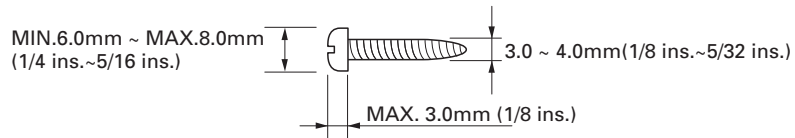
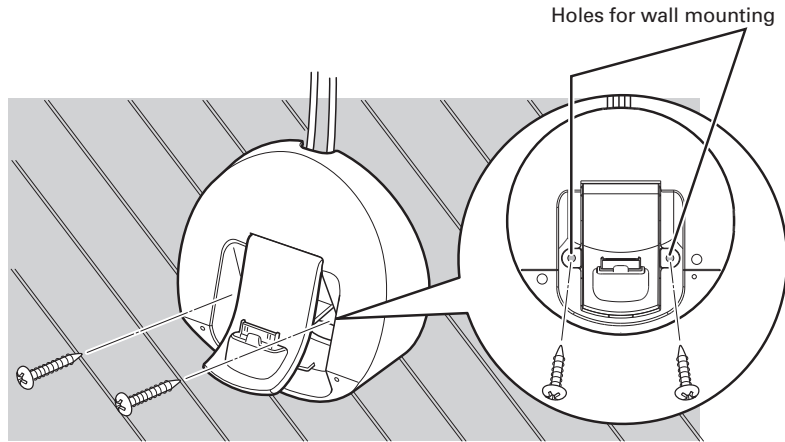

Notes

- Check that the unit is securely fixed on the wall.
- Securely connect the cables to the unit.
- To detach the unit from the wall and use it on a table, return the stopper to its original position, by holding the release button pressed, then return the handset holder to its original position.

INSTALLATION PROCEDURES FOR THE EXTENDER

The extender can be mounted on a wall or a rack, using the two holes provided on the bottom of the extender.

The extender can be installed in either a horizontal or vertical orientation. Select the orientation according to the installation conditions.

Notes

- Reception sensitivity varies, depending on the direction of the antenna. Before installing the extender, adjust the orientation of the antenna and check that radio waves can be securely received.
- The supplied wall-mounting screws are for wooden walls. If the unit is to be mounted on a wall other than wooden walls, procure commercially available screws suitable for the structure and materials of the wall.
- Before mounting on a wall, read the precautions thoroughly.

- Procure two screws that are suitable for the strength and material of the wall surface. The size of the screws is shown in the figure below.

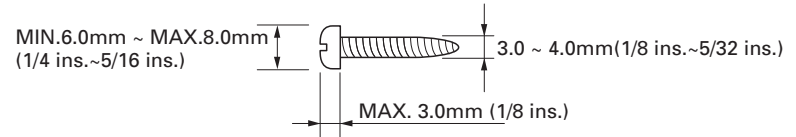

- The relative positions of the holes for wall mounting of the extender and screw-mounting positions are shown in the figure below. (Use the template provided on the last page of this manual.)

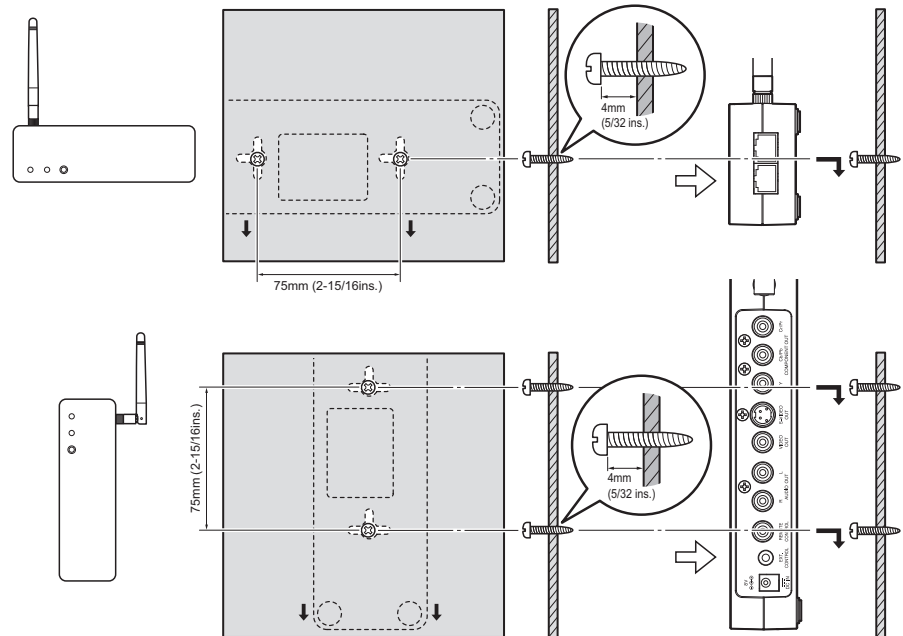

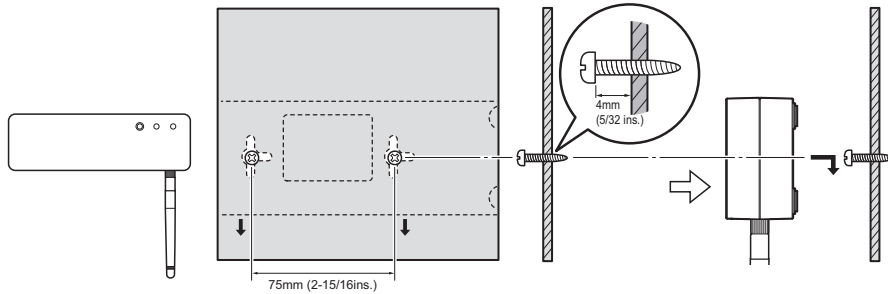

Note

When tightening the screws in the wall surface, leave a gap between the wall surface and the head of the screw, as shown in the figure.

3. Place the extender so that the two screws in the wall are inserted through the holes for wall mounting of the extender, then slide the extender downward to secure it on the wall.
4. After securing the extender on the wall, connect the AC adaptor and other cables.

Notes

- Check that the extender is securely fixed to the wall.
- Securely connect the AC adaptor and cables to the extender.

5. To detach the extender from the wall, lift it upward then pull out toward you.

USE OF THE REMOTE CONTROLLER (RC001IS)

NAMES AND FUNCTIONS OF THE REMOTE CONTROLLER

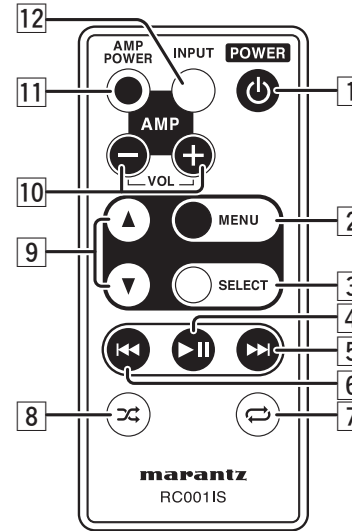

1 POWER button

Used to turn the power to the iPod on or off.

2 MENU button

This button operates in the same way as the MENU button on the iPod.

3 SELECT button

This button operates in the same way as the Select button on the iPod.

4 ►|| (Playback/pause) button

This button operates in the same way as the ►|| button on the iPod.

5 ►►| (Skip) button

Press this button once to skip to the next content.

6 ◀◀ (Back skip) button

Press this button once to return to the beginning of the content being played back. Press this button twice consecutively to return to the previous content.

7 Repeat button

Used to change the Repeat mode of the iPod. (One song → All songs → Off)

8 Shuffle button

Used to change the Shuffle mode of the iPod. (Songs → Albums → Off)

9 ▲▼ buttons

These buttons operate in the same way as the Up (▲) and Down (▼) buttons on the iPod. These buttons are also used to move the cursor. (Volume adjustment of the iPod is excluded.)

10 AMP VOL +/- buttons

Used to increase/decrease the volume of a Marantz amplifier/receiver remotely connected with this unit.

11 AMP POWER button

Used to turn ON/OFF a Marantz amplifier/receiver remotely connected with this unit.

12 AMP INPUT button

Used to switch the input sources of a Marantz amplifier/receiver remotely connected with this unit. (Some models cannot be remotely controlled with this button.)

Note

Operations of the remote controller may differ, depending on the generation and model of the iPod products.

ADVANCED OPERATIONS

BEFORE USING THE REMOTE CONTROLLER

A lithium battery comes installed in the remote controller.

Before use, pull out the insulation sheet.

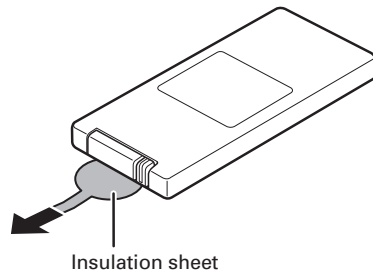

BATTERY REPLACEMENT

If the battery of the remote controller is exhausted, the operable distance of the remote controller becomes extremely short. In such a case, replace the battery with a new one.

1. Pull out the battery case, referring to the figures depicted on the rear panel of the remote controller.
2. Pull out the old lithium battery from the battery case and insert a new one. Place the battery so that the + (positive) side faces upward.
3. Replace the battery case in its original position.

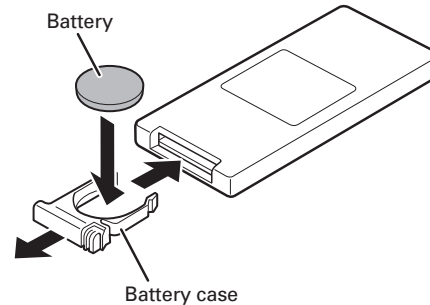

OPERABLE RANGE OF THE REMOTE CONTROLLER

The operable range of the remote controller is shown in the figure below.

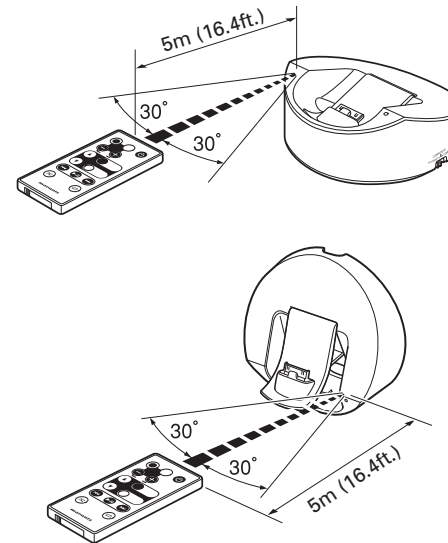

Notes On Use

- Do not allow direct sunlight, an inverter fluorescent light or other strong light to shine onto the unit's infrared signal reception window (remote sensor). Doing so may disable operation of the remote controller.
- Note that operating the remote controller may cause other devices operated by infrared rays to be operated by mistake.
- The remote controller cannot be operated if the line of sight between the remote controller and the unit's remote sensor is obstructed.
- Do not place any objects on top of the remote controller. Doing so may cause one or more buttons to be held down, which will cause the battery to run down.

CAUTIONS ON HANDLING BATTERIES

Misuse of the lithium battery can result in heat buildup, ignition, or rupture. Bear in mind the following points when using or replacing batteries.

- The supplied battery is for testing the functionality of the remote controller.
- Use a CR2032 lithium battery.
- NEVER recharge the battery.
- Do not handle the battery roughly or deconstruct the battery.
- When replacing the battery, place it with correct polarity (+ and -).
- Do not leave the battery in a place subject to high temperature, such as a place subject to direct sunlight.
- Keep the battery in a place beyond infants' or children's reach. If a battery is swallowed, consult a physician immediately.
- If electrolyte has leaked, discard the battery immediately. Be careful when handling such a battery, because if the electrolyte is attached to your skin or clothes, you may be burned. If it is accidentally attached, immediately wash with tap water then consult a physician.
- When a battery which is no longer required is to be discarded, insulate it with tape, etc. and dispose of it in a place without fire, by following the directions (regulations) laid down by the local authorities in the area concerned for its disposal.

TROUBLESHOOTING

Be sure to check the items in the following list if you experience problems. If checking the following items does not resolve your problem, please contact the retail store where you purchased your product, your nearest Marantz authorized dealer or the Marantz Service Center in your country.

Symptom	Possible cause	Resolution
No sound or video	The iPod is not properly connected with the iPod docking connector of this unit.	Disconnect the iPod from the docking connector then connect it again.
	No playback from the iPod	Play back the iPod.
	The cables connected to this unit are not fully plugged in.	Check the cable connections.
No sound	The AC adaptor is not securely connected to this unit or is unplugged from the wall outlet.	Securely connect the AC adaptor to the unit and plug it into the wall outlet.
	Pairing for Bluetooth communication has not been properly completed.	Perform pairing for Bluetooth (wireless) communication again.
	The receiver or amplifier connected to this unit is not turned on.	Turn the receiver or amplifier on.
	The input terminal on the receiver or amplifier to which the output signal from the iPod is fed is not properly selected.	Check the input of the receiver or amplifier.
No video	The volume of the receiver or amplifier to which this unit is connected is very low.	Increase the volume of the receiver or amplifier.
	Wireless connection is used.	IS-LINK connections are required.
	The video output setting of the iPod is not proper.	Check the video output setting of the iPod.
Distorted sound	The setting of the Video selection switch on the base unit is inappropriate.	Set the Video selection switch, according to the video output terminal to which the video cable is connected.
	There is a device, such as a wireless LAN or microwave, that uses radio waves in the same frequency band (2.4-GHz) as this unit.	Change the locations of the handset and extender.
No operation with the supplied remote controller	The iPod is not properly connected with the iPod docking connector of this unit.	Disconnect the iPod from the docking connector then connect it again.
	There is an object that interrupts infrared signals between the unit and the remote controller.	Remove any object between the unit and the remote controller.
	The remote control cable is not properly connected.	Check the cable connections.

OTHERS

CLEANING OF EQUIPMENT EXTERNAL SURFACES

The exterior finish of your unit will last indefinitely with proper care and cleaning. Never use scouring pads, steel wool, scouring powders or harsh chemical agents (e.g., lye solution), alcohol, thinner, benzene, insecticide or other volatile substances as these will mar the finish of the equipment. Likewise, never use cloths containing chemical substances. If the equipment get dirty, wipe the external surfaces with a soft, lint-free cloth.

If the equipment becomes heavily soiled:

- dilute some washing up liquid in water, in a ratio of one part detergent to six parts water.
- dip a soft, lint free in the solution and wring the it is damp.
- wipe the equipment with the damp cloth.
- dry the equipment by wiping it with a dry cloth.



REPAIRS

Only the most competent and qualified service technicians should be allowed to service the factory-trained warranty station personnel have the knowledge and special facilities needed for repair and calibration of this precision equipment.

After the warranty period has expired, repairs will be performed for a charge if the equipment can be returned to normal operation.

In the event of difficulty, refer to your dealer or write directly to the nearest location to you that is listed on the Marantz Authorized Service Station list. If writing, please include the model and serial number of the equipment together with a full description of what you think is abnormal about the equipment's behavior.

OTHERS

SPECIFICATIONS

IS301 (HANDSET)

Power supply 5 V DC from iPod accessory power supply
 Weight 68g/2.4ozs
 External dimensions (W/H/D)..... 67 × 105 × 30 mm (2-11/16 × 4-3/16 × 1-3/16 ins.)
 Terminals..... USB mini B

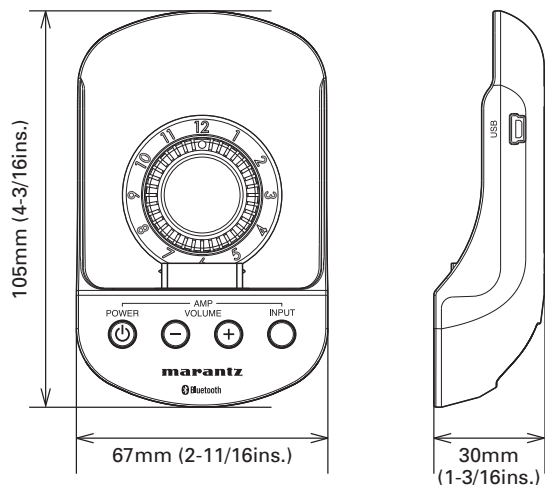

IS301DS (BASE UNIT)

Power supply 8 V DC IN (from the dedicated AC adaptor)
 Weight 230g/8.1ozs
 External dimensions (W/H/D)..... 123 × 123 × 49 mm (4-7/8 × 4-7/8 × 1-15/16 ins.)
 Terminals..... RJ-45 x2

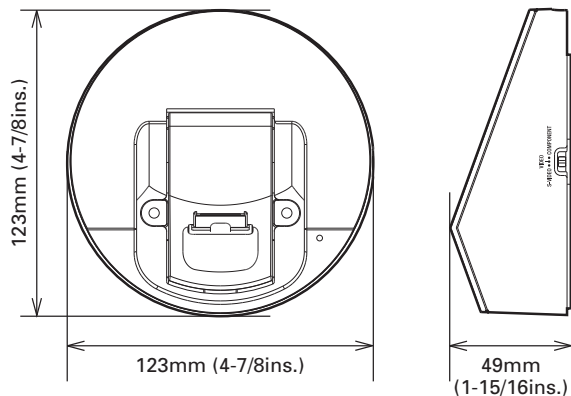

IS301RX (EXTENDER)

Power supply 8 V DC IN (from the dedicated AC adaptor)
 Weight 230g/8.1ozs
 External dimensions (W/H/D)..... 191 × 60 × 36 mm (7-9/16 × 2-3/8 × 1-7/16 ins.)
 Terminals..... Video output (S-VIDEO x1, VIDEO x1, COMPONENT x1)
 Analog audio x1, Remote terminal x1, RS-232C terminal x1, RJ-45 x2

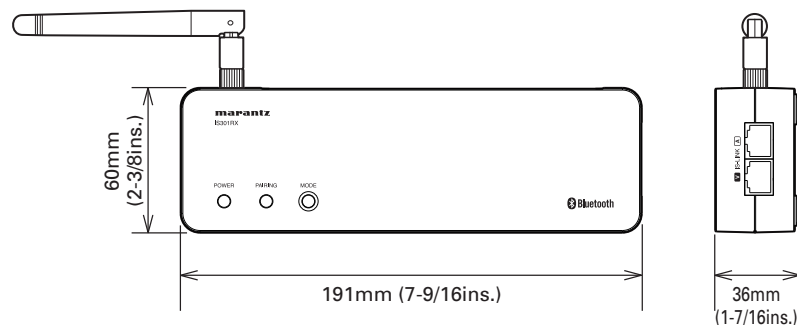

BLUETOOTH-RELATED (IS301/IS301RX)

Communication method Bluetooth ver. 2.1 + EDR
 Transmission output..... Bluetooth Power Class 2
 Maximum transmission distance..... Line-of-sight distance approx. 10 m (32.8ft.)(*1)
 Transmission frequency band 2.400 GHz to 2.4835 GHz
 Modulation method..... FH-SS
 Supporting Bluetooth profiles..... A2DP (Advanced Audio Distribution Profile),
 AVRCP (Audio Video Remote Control Profile)
 Supporting CODEC SBC (Subband Codec)
 Supporting content protection SCMS-T (Only for the IS301RX)
 Passcode..... 0000

(*1) The transmission distance is an approximate value. It may vary, depending on the ambient environment.

- The *Bluetooth*® word mark and logos are registered trademarks owned by Bluetooth SIG, Inc. and any use of such marks by D&M Holdings Inc. is under license. Other trademarks and trade names are those of their respective owners.
- Connection with all existing Bluetooth devices is not guaranteed.

SUPPLIED AC ADAPTOR

Power supply 100 V - 240 V AC (50 Hz/60 Hz) 1A

The specifications and external appearance of this unit may be changed without prior notification for the purpose of improvement.



(UNITS mm)

TEMPLATE for IS301RX INSTALLATION

エクステンダー (IS301RX) を設置する際は、CLEAR ZONE や接続する Plug などが壁や棚等の障害物に当たらないことを確認の上設置してください。

Before installing the extender (IS301RX), check the CLEAR ZONE and check that the plugs of the cables will not interfere with an object such as a wall or rack.

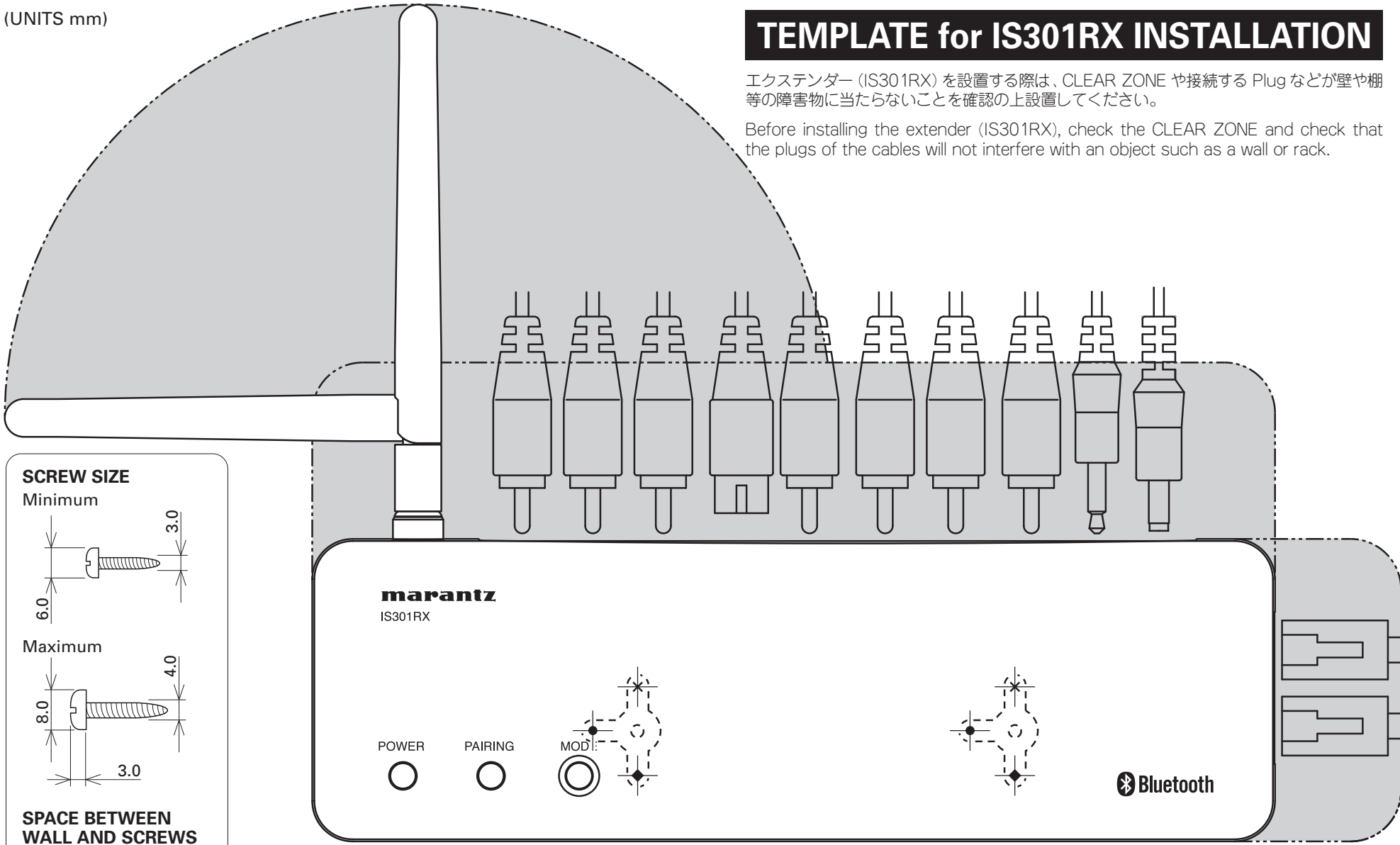

SCREW SIZE

Minimum

Maximum

SPACE BETWEEN WALL AND SCREWS

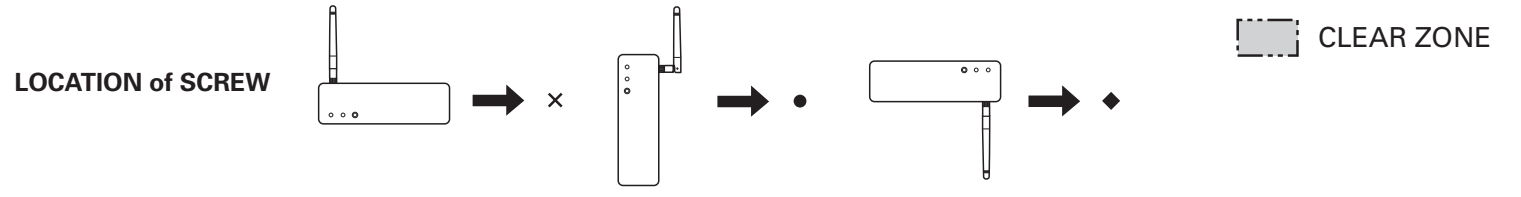

www.marantz.com

You can find your nearest authorized distributor or dealer on our website.

marantz[®] is a registered trademark.



ADDENDUM SHEET (Bluetooth)

ENGLISH

PRECAUTIONS ON BLUETOOTH COMMUNICATION

Bluetooth communication may be interfered with by the following causes,

- When you perform Bluetooth communication near metal objects
- When a device using radio waves, such as a wireless LAN device, or microwave oven, is in use near this product
- When the Bluetooth antenna is covered with obstacles such as hands.

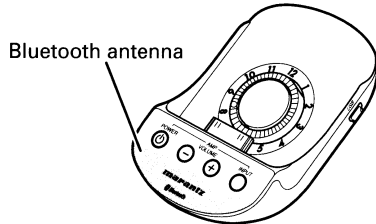

Because Bluetooth devices and wireless LAN (IEEE802.11b/g) use the same frequency, radio wave interference may occur and resulting in communication speed deterioration, noise, or invalid connection.

Microwaves emitting from Bluetooth device may affect the operation of electronic medical devices. Do not use this product in the following locations, as it may cause an accident.

- in a hospital, train, airplane
- where inflammable gas is present such as a petrol station
- near automatic doors or fire alarm

FRANÇAIS

PRÉCAUTIONS D'OPÉRATION DE COMMUNICATIONS BLUETOOTH

Les situations suivantes peuvent causer des interférences avec les communications Bluetooth,

- Si une communications Bluetooth est établie près d'objets métalliques
- Si un périphérique utilisant des ondes radio, tel qu'un périphérique réseau sans fil, ou un four à micro-ondes, est utilisé près de ce produit
- Si l'antenne Bluetooth est obstruée, comme par exemple avec les mains.

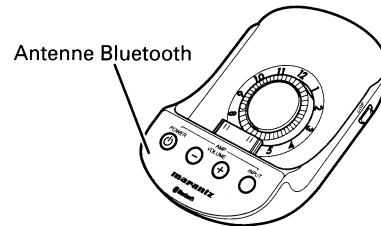

Les périphériques Bluetooth et les réseaux locaux sans fil (IEEE802.11b/g) utilisent la même fréquence. Des interférences d'ondes radio peuvent donc survenir et causer des problèmes de vitesse de communication, des parasites, ou des connexions non valides.

Les micro-ondes émises par les périphériques Bluetooth peuvent affecter l'opération d'appareils médicaux électroniques. N'utilisez pas ce produit dans les endroits suivants pour éviter de causer des accidents.

- dans un hôpital, un train, un avion
- en cas de présence de gaz inflammable, comme par exemple dans des stations d'essence
- près de portes automatiques ou d'alarmes d'incendie

DEUTSCH

SICHERHEITSHINWEISE BEI DER BLUETOOTH-KOMMUNIKATION

Die Bluetooth-Kommunikation kann durch folgende Umstände gestört werden,

- Wenn die Bluetooth-Kommunikation in der Nähe von metallenen Gegenständen ausgeführt werden soll
- Wenn ein Gerät, das Funkwellen verwendet, z. B. ein WLAN-Gerät oder ein Mikrowellen-Herd, in der Nähe dieses Produkts verwendet wird
- Wenn die Bluetooth-Antenne durch Hindernisse verdeckt ist, z. B. den Händen.

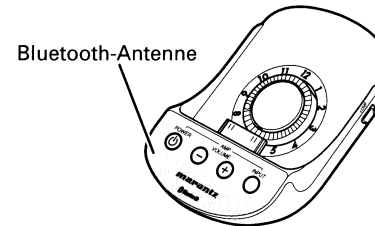

Da sowohl Bluetooth- als auch WLAN-Geräte (IEEE802.11b/g) dieselbe Frequenz verwenden, kann es zu Störungen bei der Funkübertragung kommen, die zu verlangsamer Übertragungsgeschwindigkeit, Rauschen oder einem Verbindungsabbruch führen können.

VoneinemBluetooth-GerätausgestrahlteMikrowellen beeinträchtigen möglicherweise den Betrieb von elektronischer Medizintechnik. Verwenden Sie dieses Produkt nicht an den folgenden Orten, da es sonst zu Unfällen kommen kann.

- in einem Krankenhaus, Zug oder Flugzeug
- in der Nähe von entflammabaren Gasen, z. B. an einer Tankstelle
- in der Nähe von automatischen Türen oder Brandmeldern

NEDERLANDS

OPMERKINGEN BIJ BLUETOOTH-COMMUNICATIE

Gestoorde Bluetooth-communicatie kan de volgende oorzaken hebben,

- Bluetooth-communicatie in de buurt van metalen voorwerpen
- dit toestel wordt gebruikt in de buurt van apparatuur die werkt met radiogolven, zoals bv. draadloze LAN-apparatuur
- wanneer de Bluetooth-antenne is bedekt, bv. met de handen.

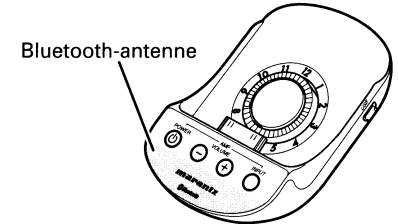

Bluetooth-apparaten en draadloze LAN-apparatuur (IEEE802.11b/g) werken op dezelfde frequentie waardoor er radiostoring kan optreden, met mogelijk minder snelle communicatie, ruis of slechte verbinding tot gevolg.

Microgolven geproduceerd door Bluetooth-apparatuur kunnen de werking van elektronische apparatuur verstoren. Gebruik dit toestel dan ook niet op de volgende plaatsen om ongevallen te voorkomen.

- in een ziekenhuis, trein, vliegtuig
- in de buurt van ontvlambare gassen, zoals bv. een tankstation
- in de buurt van automatische deuren of een brandalarm

ESPAÑOL

PRECAUCIONES SOBRE LA COMUNICACIÓN BLUETOOTH

La comunicación Bluetooth puede sufrir interferencias en las siguientes situaciones,

- al utilizar la comunicación Bluetooth cerca de objetos metálicos
- si el producto se encuentra cerca de un dispositivo emisor de ondas de radio, como por ejemplo un dispositivo LAN inalámbrico o un horno microondas
- si la antena Bluetooth está cubierta por algún obstáculo, como por ejemplo las manos.

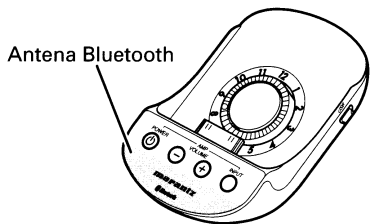

Debido a que los dispositivos Bluetooth y las LAN inalámbricas (IEEE802.11b/g) utilizan la misma frecuencia, es posible que se produzcan interferencias en las ondas de radio y que, como consecuencia, se reduzca la velocidad de comunicación, se oigan ruidos o se produzca una conexión inválida.

Las microondas procedentes de un dispositivo Bluetooth pueden afectar al funcionamiento de los dispositivos médicos electrónicos. No utilice este producto en los siguientes lugares, puesto que podría provocar un accidente.

- en hospitales, trenes y aviones
- en lugares donde haya gases inflamables, como por ejemplo una estación de servicio
- cerca de una puerta automática o de una alarma de incendios

ITALIANO

PRECAUZIONI PER LA COMUNICAZIONE BLUETOOTH

La comunicazione Bluetooth può subire interferenze per le seguenti cause,

- Se la comunicazione Bluetooth avviene in prossimità di oggetti metallici
- Quando un dispositivo che utilizza onde radio, per esempio un dispositivo LAN wireless o un forno a microonde, è utilizzato in prossimità del prodotto
- Quando l'antenna Bluetooth è coperta da ostacoli, per esempio le mani.

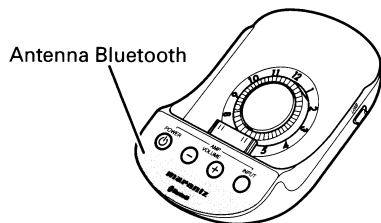

Poiché i dispositivi Bluetooth e le LAN wireless (IEEE802.11b/g) utilizzano la stessa frequenza, eventuali interferenze tra le onde radio possono causare una riduzione della velocità di comunicazione, disturbi o una connessione non valida.

Le microonde emesse dal dispositivo Bluetooth possono compromettere il funzionamento di dispositivi medici elettronici. Non utilizzare il prodotto nei seguenti luoghi per non causare incidenti.

- in ospedale, treno, aereo
- in presenza di gas infiammabili, per esempio nelle stazioni di servizio
- in prossimità di porte automatiche o allarmi antincendio

SVENSKA

SÄKERHETSÅTGÄRDER GÄLLANDE BLUETOOTH-KOMMUNIKATION

Följande orsaker kan leda till störningar i Bluetooth-kommunikation,

- När du utför Bluetooth-kommunikation i närheten av metallföremål
- När en apparat som använder mikrovågor, t.ex. en trådlös LAN-enhet eller mikrovågsugn används i närheten av denna produkt
- När Bluetooth-antennen är täcks av något, t.ex. händer.

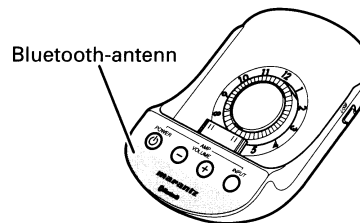

Eftersom Bluetooth-enheter och trådlöst LAN (IEEE802.11b/g) använder samma frekvens kan det förekomma radiovågstörningar som leder till långsammare kommunikationshastighet, störningar eller en ogiltig anslutning.

Mikrovågor från Bluetooth-enheten kan påverka användning av elektroniska medicinska apparater. Använd inte produkten på följande platser, eftersom den kan orsaka en olycka.

- på sjukhus, tåg, flygplan
- där det finns lättantändlig gas, t.ex. vid en bensinstation
- nära automatiska dörrar eller brandlarm

日本語

Bluetooth 通信における使用上のご注意

以下の場合には、Bluetooth 通信に障害を起こす場合があります。

- 金属物の近くで Bluetooth 通信を行なっているとき
- 無線 LAN が構築されている場所、電子レンジを使用中の周辺、またはその他電磁波が発生している場所などで Bluetooth 通信を行なっているとき
- 本機の Bluetooth アンテナ部分が手などでおおわれているとき

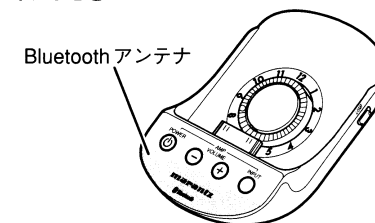

Bluetooth 機器と無線 LAN (IEEE802.11b/g) は同一周波数帯 (2.4GHz 帯) を使用するため、無線 LAN を搭載した機器の近辺で使用すると、電波干渉が発生し、通信速度の低下、雑音や接続不能の原因になる場合があります。

Bluetooth 機器が発生する電波は、電子医療機器などの動作に影響を与える可能性があります。場合によっては事故を発生させる原因になりますので、次の場所では本機を使用しないでください。

- 病院内 / 電車内 / 航空機内
- ガソリンスタンドなど引火性ガスの発生する場所
- 自動ドアや火災報知機の近く

ADDENDUM SHEET

ENGLISH

At upper right, page 3

① USB connector

When an iPod is connected to your PC via the USB connector on the handset, the PC may not recognize the iPod, depending on the type of iPod used or PC environment. In such a case, detach then reattach the iPod from/to the handset, or use the USB cable supplied with the iPod.

At lower right, page 9

IN A CASE WHERE THE IPOD AND HANDSET ARE USED DETACHED FROM THE BASE UNIT

- If the iPod is turned on when the iPod and the handset are detached from the base unit, the handset may not turn on, depending on the type of iPod or the state of the internal battery of the iPod. In such a case, connect the iPod and handset to the base unit then turn on the handset. Then detach the handset and iPod from the base unit.

At lower left, page 10

Notes

The video playback signal may not be output from the iPod immediately after the iPod is attached to the handset and the base unit that is connected with the extender via the IS-LINK cables. In such a case, wait a while, go back to the MENU screen for video selection on the iPod, then restart playback.

FRANÇAIS

Au coin supérieur droit, page 3

① Connecteur USB

Si un iPod est connecté à l'ordinateur via le connecteur USB du berceau, il est possible que l'ordinateur ne reconnaisse pas l'iPod, selon le type d'iPod ou le système d'exploitation de l'ordinateur. Dans ce cas, débranchez puis rebranchez l'iPod du/au berceau ou utilisez le câble USB fourni avec l'iPod.

Au coin inférieur droit, page 9

SI L'IPOD ET LE BERCEAU NE SONT PAS CONNECTÉS À L'UNITÉ DE BASE

- Si l'iPod est allumé lorsque l'iPod et le berceau ne sont pas connectés à l'unité de base, il est possible que le berceau ne s'allume pas, selon le type d'iPod ou l'état de la pile de l'iPod. Dans ce cas, connectez l'iPod et le berceau à l'unité de base, puis allumez le berceau. Retirez alors le berceau et l'iPod de l'unité de base.

Au coin inférieur gauche, page 10

Remarques

Il est possible que le signal de lecture vidéo ne soit pas émis immédiatement de l'iPod lorsque l'iPod est attaché au berceau, et l'unité de base est connectée à l'extendeur via les câbles IS-LINK. Dans ce cas, patientez un instant avant de retourner à l'écran MENU de sélection vidéo sur l'iPod, puis relancez la lecture.

DEUTSCH

Oben rechts, Seite 3

① USB-Anschluss

Wenn ein iPod über den USB-Anschluss an Ihren PC angeschlossen ist, erkennt der PC den iPod möglicherweise nicht, abhängig vom verwendeten iPod-Typ oder der PC-Umgebung. Stecken Sie in einem solchen Fall den iPod in das Handset und ziehen ihn anschließend wieder ab, oder verwenden Sie das USB-Kabel, das im Lieferumfang des iPod enthalten war.

Unten rechts, Seite 9

WENN DER IPOD UND DAS HANDSET VON DER BASIS-EINHEIT GETRENNT VERWENDET WERDEN

- Wenn der iPod eingeschaltet ist und der iPod und das Handset von der Basiseinheit getrennt verwendet werden, kann das Handset möglicherweise nicht angeschlossen werden, abhängig vom verwendeten iPod-Typ und dem Ladezustand des internen iPod-Akkus. Schließen Sie in diesem Fall den iPod und das Handset an die Basiseinheit an und schalten Sie anschließend das Handset ein. Trennen Sie dann das Handset und den iPod von der Basiseinheit.

Unten links, Seite 10

Hinweise

Das Videowiedergabesignal kann vom iPod möglicherweise nicht direkt im Anschluss an die Verbindung mit dem Handset und der Basiseinheit ausgegeben werden, die mithilfe der IS-LINK-Kabel an die Erweiterungseinheit angeschlossen ist. Warten Sie in einem solchen Fall einen Augenblick und gehen Sie zurück zu „MENU“ zwecks Videoauswahl auf dem iPod, um die Videowiedergabe erneut zu starten.

NEDERLANDS

Bovenaan rechts, pagina 3

① USB-aansluiting

Wanneer een iPod met uw PC is verbonden via de USB-aansluiting op de handset, kan de PC de iPod mogelijk niet herkennen afhankelijk van het gebruikte type iPod of de PC-omgeving. In dat geval moet u de iPod loskoppelen van en weer aansluiten op de handset of de USB-kabel gebruiken die is meegeleverd met de iPod.

Onderaan rechts, pagina 9

IN EEN GEVAL WAARBIJ DE IPOD EN HANDSET WORDEN GEBRUIKT TERWIJL ZE NIJN LOSGEKOPPELD VAN DE BASIS-EENHEID

- Indien de iPod wordt ingeschakeld terwijl de iPod en handset zijn losgekoppeld van de basiseenheid, schakelt de handset mogelijk niet in afhankelijk van het type iPod of de status van de interne batterij van de iPod. Sluit in dat geval de iPod en handset aan op de basiseenheid en schakel de handset in. Koppel vervolgens de handset en iPod los van de basiseenheid.

Onderaan links, pagina 10

Opmerkingen

De iPod voert mogelijk niet meteen het videoweergavesignaal uit nadat de iPod is bevestigd op de handset en de basiseenheid die via de IS-LINK-kabels is verbonden met de extender. Wacht in dat geval een tijdje, ga terug naar het MENU-scherm voor videoselectie op de iPod en start de weergave opnieuw.

ESPAÑOL

Parte superior derecha, página 3

① Conector USB

Al conectar un iPod al PC utilizando el conector USB del soporte manual, es posible que, dependiendo del tipo de iPod utilizado o del entorno informático del PC, éste no reconozca el iPod. En este caso, separe y vuelva a acoplar el iPod en el soporte manual o utilice el cable USB suministrado con el iPod.

Parte inferior derecha, página 9

EN CASO DE QUE EL IPOD Y EL SOPORTE MANUAL SE UTILICEN SEPARADOS DE LA UNIDAD BASE

- Al encender el iPod mientras el iPod y el soporte manual están separados de la unidad base, es posible que el soporte manual no se encienda, dependiendo del tipo de iPod o del nivel de carga de la batería interna del mismo. En este caso, conecte el iPod y el soporte manual a la unidad base y encienda el soporte manual. Acto seguido, desconecte el soporte manual y el iPod de la unidad base.

Parte inferior izquierda, página 10

Notas

Es posible que el iPod no transmita inmediatamente la señal de reproducción de vídeo después de conectarlo al soporte manual y a la unidad base que se conecta mediante el extensor a través de los cables IS-LINK. En este caso, espere unos instantes, regrese a la pantalla MENU para seleccionar el vídeo en el iPod e inicie la reproducción de nuevo.

ITALIANO

In alto a destra, pagina 3

① Connettore USB

Se un iPod è collegato al PC mediante il connettore USB sul dispositivo, il PC potrebbe non riconoscere l'iPod, a seconda del tipo di iPod utilizzato o dell'ambiente del PC. In tal caso, scollegare e ricollegare l'iPod dal/al dispositivo, oppure utilizzare il cavo USB in dotazione con l'iPod.

In basso a destra, pagina 9

NEL CASO IN CUI L'IPOD E IL DISPOSITIVO SIANO UTILIZZATI SCOLLEGATI DALL'UNITÀ BASE

- Se l'iPod viene acceso quando l'iPod e il dispositivo sono scollegati dall'unità base, il dispositivo potrebbe non accendersi, a seconda del tipo di iPod o dello stato della batteria interna dello stesso. In tal caso, collegare l'iPod e il dispositivo all'unità base e accendere il dispositivo. Quindi, scollegare il dispositivo e l'iPod dall'unità base.

In basso a sinistra, pagina 10

Note

Il segnale di riproduzione video potrebbe non essere emesso dall'iPod subito dopo aver collegato l'iPod al dispositivo e all'unità base collegata con il sistema di estensione mediante i cavi IS-LINK. In tal caso, attendere qualche istante, tornare alla schermata MENU per la selezione del video sull'iPod e riavviare la riproduzione.

SVENSKA

Uppe till höger, sidan 3

① USB-anslutning

När en iPod är ansluten till din dator via USB-anslutningen på handenheten kanske datorn inte känner igen din iPod, beroende på vilken typ av iPod eller datormiljö som används. I sådant fall ska du lösgöra och sedan fästa din iPod vid handsetet igen eller använda USB-kabeln som medföljde din iPod.

Nere till höger, sidan 9

IFALL IPODEN OCH HANDSETET ANVÄNDS LÖSGJORDA FRÅN BASENHETEN

- Om din iPod aktiveras när både iPod och handenhet är urkopplade från basenheten, kanske handenheten inte aktiveras, beroende på typ av iPod eller skicket på dess interna batteri. I sådant fall ska du ansluta din iPod och handenheten till basenheten och sedan aktivera handenheten. Koppla sedan loss handenheten och din iPod från basenheten.

Nere till vänster, sidan 10

Observera

Videouppspelningsignalen kanske inte matas ut från din iPod med detsamma efter att din iPod har anslutits till handenheten och basenheten som är ansluten med förlängningskabeln via IS-LINK-kablarna. I sådant fall ska du vänta ett tag och sedan gå tillbaka till skärmen MENU för att välja video på din iPod och sedan starta om uppspelningen.

日本語

3 ページ右上

① USB コネクタ

ハンドセットにある USB 端子を使用して iPod を PC と接続する場合、ご使用の iPod または環境によって、PC が iPod を認識できない場合があります。その場合は一度 iPod をハンドセットから抜き差しするが、iPod 付属の USB ケーブルをご使用下さい。

9 ページ右下

ハンドセットと iPod をベースユニットから取り外した状態で使用する場合

- この状態で iPod の電源を入れると iPod の種類や内蔵バッテリーの状態によってハンドセットが起動しない場合があります。その場合は iPod とハンドセットを一度ベースユニットに接続し、ハンドセットを起動させその後、再度ハンドセットと iPod をベースユニットから取り外して使用下さい。

10 ページ左下

ご注意

iPod のビデオ再生出力する場合、iPod をハンドセットと IS-LINK 接続されたベースユニットに接続した直後はビデオ再生出力を開始できない場合があります。ビデオ再生出力ができない場合は、しばらく待ってから、再度 iPod のビデオ選択メニューに戻り再生をスタートしてください。

Connection Image



Audio Equipment
(Option)



Accessory

Audio-Control Signals

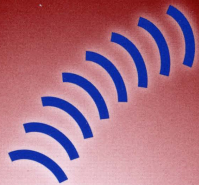

Wireless Connection by
Bluetooth®
Wireless technology

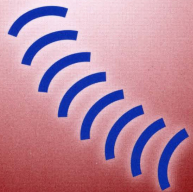

A

Wireless Connection

Display box (Assembly)

1

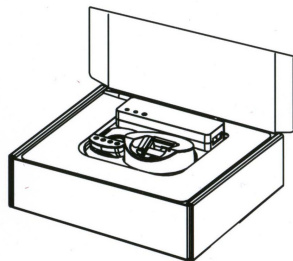

2

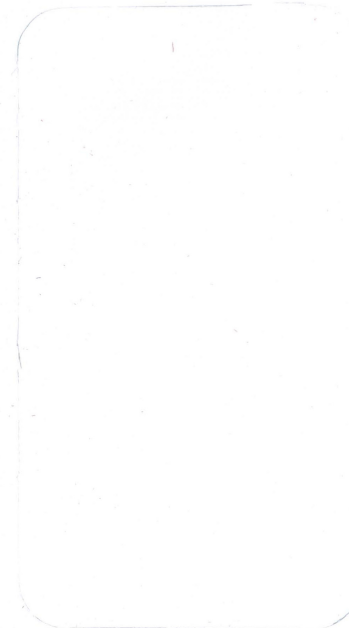
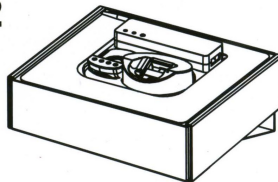

Audio-Control Signals

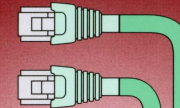

Video Signals

Wired Connection by
CAT5 Cables

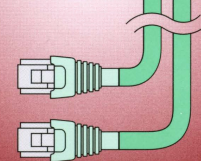

B

Wired Connection



Supported iPod Models

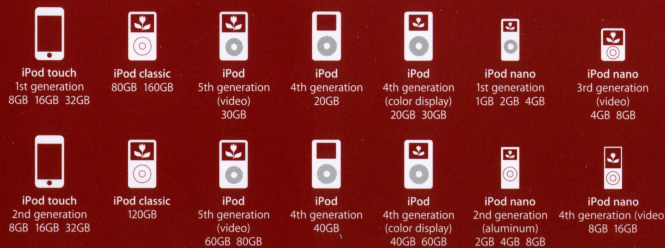

IS301 WIRELESS DOCK for iPod

- Enjoy the contents of your iPod on your Home Audio or AV System
- Selectable Wired or Wireless connection
- Easily adapts to virtually any iPod
- Charges the iPod while in the Base Unit
- Base Unit / Extender are Tabletop or Wall Mountable

Information for Users on Collection and Disposal of Old Equipment and used Batteries

When discarding the unit, comply with local rules or regulations.
Batteries should never be thrown away or incinerated but disposed of in accordance with the local regulations concerning battery disposal.



Verbraucherinformation zur Sammlung und Entsorgung alter Elektrogeräte und benutzter Batterien

Beachten Sie bei der Entsorgung des Gerätes die örtlichen Vorschriften und Bestimmungen.
Die Batterien dürfen nicht in den Hausmüll geworfen oder verbrannt werden; bitte entsorgen Sie die Batterien gemäß der örtlichen Vorschriften.



Information concernant la Collecte et le Traitement des piles usagées et des déchets d'équipements électriques et électroniques

Lorsque vous mettez cet appareil au rebut, respectez les lois ou réglementations en vigueur.
Les piles ne doivent jamais être jetées ou incinérées, mais mises au rebut conformément aux lois en vigueur sur la mise au rebut des piles.



Pb

Informazioni per gli utenti sulla raccolta e lo smaltimento di vecchia attrezzatura e batterie usate

Per lo smaltimento dell'unità, osservare le normative o le leggi locali in vigore.
Non gettare le batterie, né incenerirle, ma smaltirle conformemente alla normativa locale sui rifiuti chimici.

Información para Usuarios sobre Recolección y Disposición de Equipamiento Viejo y Baterías usadas

Cuando se deshaga de la unidad, cumpla con las reglas o reglamentos locales.
Las pilas nunca deberán tirarse ni incinerarse. Deberá disponer de ellas siguiendo los reglamentos de su localidad relacionados con los desperdicios químicos.

Informatie voor gebruikers van inzameling en verwijdering van oude apparaten en gebruikte batterijen

Volg voor het wegdoen van de speler de voorschriften voor de verwijdering van wit- en bruingoed op.
Batterijen mogen nooit worden weggegooid of verbrand, maar moeten volgens de plaatselijke voorschriften betreffende chemisch afval worden verwijderd.

Användarinformation, beträffande insamling och dumpning av gammal utrustning och använda batterier

När du kasserar enheten ska du göra det i överensstämmelse med lokala regler och bestämmelser.
Batterier får absolut inte kastas i soporna eller brännas. Kassera dem enligt lokala bestämmelser för kemiskt avfall.

marantz®

GARANTIE LIMITÉE DE MARANTZ CANADA

Marantz Canada ("Marantz") garantit les produits suivants pour les périodes indiquées :

3 ans de garantie pour les pièces et la main d'œuvre prenant effet à partir de la date d'achat du produit :

Amplificateurs, Préamplificateurs, Pré-ampli-processeurs-syntoniseurs; amplificateurs intégrés, syntoniseurs, récepteurs, lecteurs DVD, enregistreurs CD, lecteurs CD, platines à cassette audio, télécommandes programmables, Dock universel, système de cinéma à domicile, caisson de basse et projecteurs avant DLP.

1 an de garantie pour les pièces et la main d'œuvre prenant effet à partir de la date d'achat du produit :

Magnétoscope numérique HD

90 jours de garantie pour les pièces et la main d'œuvre prenant effet à partir de la date d'achat du produit :

Lampes DLP

3 ans de garantie pour la main d'œuvre, 2 ans de garantie pour les pièces et un an de garantie pour le panneau :

Ecrans à plasma

Ce qui est couvert et pas couvert par la garantie :

A l'exception de ce qui est mentionné ci-dessous, cette garantie couvre les pièces et la main d'œuvre afin de réparer tous les défauts de matériel ou de fabrication du produit. Ce qui suit n'est pas couvert par la garantie :

1. Les dommages, détérioration, défauts de fonctionnement, ou le fait de ne pas respecter les spécifications d'exécutions résultant d'un (e) :
 - a) accident, acte de la nature, abus, négligence, utilisation impropre ou d'une modification de produit non autorisée ;
 - b) installation incorrecte, déplacement, maintenance ou d'un emploi contraire aux instructions fournies avec le produit ;
 - c) réparations ou tentatives de réparations par une personne non reconnue par Marantz ;
 - d) envoi de produit (les réclamations doivent être présentées au transporteur)
 - e) cause autre qu'un défaut de produit.
2. L'entretien, l'installation initiale, toute vérification de produit ou aucun défaut n'a été trouvé, ou tous frais encourus pour l'installation, le déplacement ou la réinstallation du produit.
3. Tout produit dont le numéro de série a été effacé, modifié ou enlevé.
4. Les accessoires incluant mais non limités aux, piles, câbles, matériaux de support, accessoires de nettoyage, antennes et cordons de secteur détachables.
5. La garantie n'est pas valable si l'achat a été fait au Canada chez un revendeur non reconnu par Marantz.

Qui peut faire appliquer la garantie

Seule la personne qui a acheté le produit à l'origine peut faire appliquer la garantie.

Notre paiement

Nous paierons tous les frais de pièces et de main d'œuvre pour tous les produits couverts par la garantie. Le paiement des frais de livraison est abordé dans la section suivante de cette garantie.

Comment vous pouvez obtenir le service de réparation

1. Si vous avez besoin de faire réparer votre appareil, vous pouvez l'envoyer ou le déposer chez un atelier de service autorisé Marantz ou directement chez Marantz Canada (Dans le cas où vous n'êtes pas sûr de savoir si un atelier de service est autorisé ou non à réparer votre appareil, vous pouvez contacter Marantz Canada à l'adresse et au numéro de téléphone ci-dessous). Veuillez ne pas renvoyer votre appareil à l'usine sans autorisation préalable.
2. Vous devez payer les frais de livraison dans le cas où votre appareil a besoin d'être envoyé au service des réparations. Toutefois, si les réparations nécessaires sont couvertes par la garantie, nous payerons les frais de retour d'expédition et ce quelle que soit la destination au Canada.
3. Lorsque vous envoyez votre appareil pour un service sous garantie, vous devez joindre une copie de la facture d'achat (ticket ou autre preuve d'achat)

Limites des garanties implicites

Toutes les garanties implicites, y compris les garanties de valeur marchande et spécifique pour un achat particulier, sont limitées dans la durée à la longueur de cette garantie.

Exclusion des dommages

La responsabilité de Marantz est limitée pour n'importe quel produit défectueux en ce qui concerne la réparation ou le remplacement du produit en question. Si des dommages interviennent à des produits autres que ceux de Marantz, Marantz ne sera pas tenu responsable des dits dommages, basés sur le dérangement ou la perte d'utilisation du produit ou tout autre dommage qu'il soit fortuit, indirect ou autre.

Certaines provinces ne permettent pas de limites quant à la durée d'une garantie sous-entendue et/ou ne permettent pas l'exclusion de dommages fortuits ; ainsi les limitations et les exclusions mentionnées ci-dessus peuvent ne pas s'appliquer à votre cas.

Cette garantie vous donne des droits légaux spécifiques, mais vous pouvez aussi avoir d'autres droits qui peuvent varier d'une province à l'autre.

Cette garantie n'est seulement valable qu'au Canada.

MARANTZ Canada

Division of D&M Canada Inc.
5-505 Apple Creek Blvd.,
Markham, Ontario
L3R 5B1
1-888-258-9361
www.marantz.com

For CANADA

marantz®

MARANTZ CANADA LIMITED WARRANTY

Marantz Canada ("Marantz") warrants the following Marantz products for the periods indicated:

3-year warranty for both Parts & Labour, from the original purchase date :

Amplifiers; Pre Amplifiers; Pre Amplifier-Processor-Tuners; Integrated Amplifiers; Tuners; Receivers; DVD Players; CD-Recorders; CD Players; Audio Cassette Decks; Learning Remote Control Devices; Universal Dock; Home Theater Systems; Subwoofers & DLP front Projectors.

1 year warranty for parts and labour from the original purchase date :

HD Digital VCR's

90 day warranty for parts and labour from the original purchase date :

DLP lamps

3-year warranty for Labour, 2-year warranty for parts and 1-year warranty for the Panel :

Plasma Displays

What is Covered and What is Not Covered

Except as specified below, this warranty covers parts and labor to correct all defects in materials and workmanship. The following are not covered by the warranty:

1. Damage, deterioration, malfunction or failure to meet performance specifications resulting from:
 - a) Accident; acts of nature; misuse; abuse; neglect; unauthorized product modification.
 - b) Improper installation, removal or maintenance, or failure to follow instructions supplied with the product.
 - c) Repair or attempted repair by anyone not authorized by Marantz to repair the product.
 - d) Any shipment of the product (claims must be presented to the carrier)
 - e) Any cause other than a product defect
2. Cleaning, initial set-up, check-ups with no defects found, or charges incurred for installation, removal or reinstallation of the product.
3. Any product on which the serial number has been defaced, modified or removed.
4. Accessories, including but not limited to, batteries, cables, mounting hardware and brackets, cleaning accessories, antenna and detachable power cords.
5. Warranty is void if purchase was made from anyone other than an authorized Marantz dealer.

Who May Enforce the Warranty

Only the original purchaser may enforce this warranty.

What We Will Pay For

We will pay for all labor and material expenses for items covered by the warranty. Payment of shipping charges is discussed in the next section of this warranty.

How You Can Get Service

1. If your unit needs service, it may be taken or shipped to any authorized MARANTZ service station or MARANTZ CANADA (if you are uncertain as to whether a service station is MARANTZ authorized, please contact MARANTZ as listed below). Please do not return your unit to the factory without prior authorization.
2. You must pay any shipping charged if it is necessary to ship the product for service. However, if the necessary repairs are covered under warranty, we will pay the return shipping charges to any destination within Canada.
3. Whenever warranty service is required, you must present the original dated sales receipt or other proof of date of purchase.

Limitation of Implied warranties

All implied warranties, including warranties of merchantability and fitness for a particular purchase, are limited in duration to the length of this warranty.

Exclusion of damages

Marantz liability for any defective product is limited to repair or replacement of the product at Marantz's option. Marantz shall not be liable for damage to other products caused by any defects in Marantz products, damages based upon inconvenience or loss of use of the product, or any other damages, whether incidental, consequential, or otherwise.

Some provinces do not allow limitations on how long an implied warranty lasts and/or does not allow the exclusion of incidental or consequential damages, so the above limitations and exclusions may not apply to you.

This warranty gives you specific legal rights, but you may also have other rights, which vary from province to province.

MARANTZ Canada

Division of D&M Canada Inc.
5-505 Apple Creek Blvd.,
Markham, Ontario
L3R 5B1
1-888-258-9361
www.marantz.com

For U.S.A.

marantz®

Limited Warranty

Marantz America, Inc. ("Marantz") warrants the following Marantz Products for the periods indicated:

1. The following Marantz Audio/Video components, have a 3 year warranty for both Parts & Labor, from the original purchase date:
Amplifiers, Pre Amplifiers, Pre Amplifier-Processor-Tuners, Integrated Amplifiers, Tuners, Receivers, DVD Players, CD-Recorders, CD Players, Audio Cassette Decks, Learning Remote Control Devices, Universal Dock, Home Theater Systems, Subwoofers & DLP front Projectors.
2. **VCR's, Wallvisions, Plasma TVs, LCD TVs & HDD Products** have a 1 year warranty for parts and labor from the original purchase date.
3. **Rear Projection TVs** have a 2 year warranty for parts and labor from the original purchase date.
4. **DLP lamps** have a 90 day warranty for parts and labor from the original purchase date.

What is covered and what is not covered

Except as specified below, this warranty covers parts and labor to correct all defects in materials and workmanship. The following are not covered by the warranty:

1. Damage, deterioration, malfunction or failure to meet performance specifications resulting from:
 - a) Accident, acts of nature, misuse, abuse, neglect or unauthorized product modification.
 - b) Improper installation, removal or maintenance, or failure to follow instructions supplied with the product.
 - c) Repair or attempted repair by anyone not authorized by Marantz to repair the product.
 - d) Any shipment of the product (claims must be presented to the carrier).
 - e) Any cause other than a product defect.
2. Cleaning, initial set-up, check-ups with no defects found, or charges incurred for installation, removal or reinstallation of the product.
3. Any product on which the serial number has been defaced, modified or removed.
4. Batteries.
5. Accessories, including but not limited to, batteries, cables, mounting hardware and brackets, cleaning accessories, antenna and detachable power cords.
6. Warranty is void if purchase was made from any one other than an authorized Marantz dealer.

Marantz America, Inc.

100 Corporate Drive,
Mahwah, NJ, 07430
Phone. 800-654-6633 Fax. 201-762-6686

Who may enforce the warranty

This warranty may be enforced only by the original purchaser.

What we will pay for

We will pay for all labor and material expenses for items covered by the warranty. Payment of shipping charges is discussed in the next section of this warranty.

How you can get service

1. If your unit needs service, contact Marantz service referral by calling toll-free **1-800-270-4533**. We will advise you of the name and location of one or more authorized Marantz service stations from which service can be obtained. Please do not return your unit to the factory without prior authorization.
2. You must pay any shipping charged if it is necessary to ship the product for service. However, if the necessary repairs are covered under warranty, we will pay the return shipping charges to any destination within the United States, its possessions or territories.
3. Whenever warranty service is required, you must present the original dated sales receipt or other proof of date of purchase.

Limitation of implied warranties

All implied warranties, including warranties of merchantability and fitness for a particular purchase, are limited in duration to the length of this warranty.

Exclusion of damages

Marantz liability for any defective product is limited to repair or replacement of the product at Marantz's option. Marantz shall not be liable for damage to other products caused by any defects in Marantz products, damages based upon inconvenience or loss of use of the product, or any other damages, whether incidental, consequential, or otherwise.

How state law relates to the warranty

Some states do not allow limitations on how long an implied warranty lasts and/or do not allow the exclusion or limitation of incidental or consequential damages, so the above limitations or exclusions may not apply to you.

This warranty gives you specific legal rights, and you may also have other rights which vary from state to state.