



beats™ by dr. dre™



manual and warranty



Important Performance and Safety Tips for your Headphones

Listen Responsibly

To avoid hearing damage, make sure that the volume on your music player is turned down before connecting your headphones. After placing headphones in your ears, gradually turn up the volume until you reach a comfortable listening level.

Noise levels are measured in decibels (dB), exposure to any noise at or above 85 dB can cause gradual hearing loss.

Monitor your use; hearing loss is a function of loudness versus time. The louder it is, the less time you can be exposed to it. The softer it is, the more time you can listen to it. Refer to the chart* on the following page.

This decibel (dB) table compares some common sounds and shows how they rank in potential harm to hearing.

SOUND	NOISE LEVEL (dB)	EFFECT
Whisper	30	Very quiet
Quiet Office	50-60	Comfortable hearing levels are under 60 dB
Vacuum Cleaner, Hair Dryer	70	Intrusive; interferes with telephone conversations
Food Blender	85-90	85 dB is the level at which hearing damage (8 hrs.) begins
Garbage Truck, Cement Mixer	100	No more than 15 minutes of unprotected exposure recommended for sounds between 90-100 dB
Power Saw, Drill/ Jackhammer	110	Regular exposure to sound over 100 dB of more than 1 minute risks permanent hearing loss
Rock Concerts (varies)	110-140	Threshold of pain begins around 125dB

*Chart information obtained from http://www.nidcd.nih.gov/health/education/teachers/common_sounds.asp

*"...a typical person can safely listen to an iPod for 4.6 hours per day at 70% volume."
"...knowing the levels one is listening to music at, and for how long
is extremely important."*

From <http://www.cbc.ca/health/story/2006/10/19/music-earphones.html>

Get the most out of your equipment and enjoy great audio performance even at safe levels. Our headphones will allow you to hear more details at lower volume levels than ever before.

Physiology of the Ear and Hearing

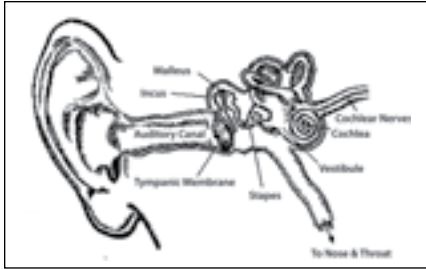

For additional information on what loud noises do to your ear and chart reference
<http://www.abelard.org/hear/hear.php#loud-music>

Use Responsibly

Do not use headphones when it's unsafe to do so – while operating a vehicle, crossing streets, or during any activity or in an environment where your full attention to your surroundings is required.

It's dangerous to drive while wearing headphones, and in many places, illegal because it decreases your chances of hearing life-saving sounds outside of your vehicle, such as another car's horn and emergency vehicle sirens.

Please avoid wearing your headphones while driving. Use one of Monster's FM transmitters to listen to your mobile media devices instead.

Learn how to establish a safe listening level and review other important safety guidelines from the Consumer Electronics Association at www.ce.org.

Important information on how to prevent Noise-Induced Hearing Loss (NIHL) and a comprehensive list of which noises can cause damage can be found on the Deafness Research Foundation's website, www.drf.org <http://www.drf.org>.

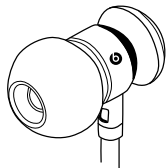

Eartip Selection

The tips on the ends of your iBeats™ make the difference between good sound and great sound. With the right fit, you'll get better isolation from unwanted outside noise, increased bass response, better tonal balance and the headphones will stay in your ears better. Of course, the right fit will also feel more comfortable. Because everyone's ears are unique, Monster supplies several sizes and designs of eartips. Getting the perfect fit with the correct tip is a matter of experimentation. Try out all the eartips included with your iBeats headphones to find the best fit for the size and shape of your ear canal.

Monster recommends that you try the smallest tip first and work upwards in size until you find a comfortable fit that has a good seal and also stays in your ears without falling out. Also try different style tips to see which works best for you.

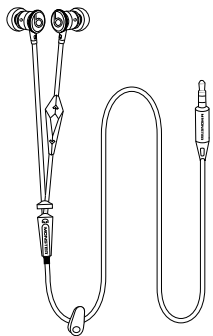

Connect

Plug the iBeats cable into the 1/8" (3.5mm) stereo plug on your music player.

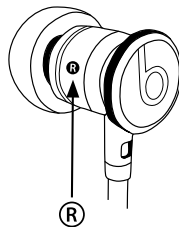

Listen

Turn down the volume on your music player before inserting iBeats™ headphones.

IMPORTANT: Left and Right Headphone: Having the correct headphone side in the correct ear does affect the listening experience.

Note the "L" and "R" markings on the side of each headphone. "L" is for the left ear. "R" is for the right ear.



Excessive listening levels can cause permanent hearing damage. Avoid loud listening, especially for extended periods of time.

Proper Insertion and Removal of Eartips

1. You may wish to lightly moisten your eartips for easier insertion.
2. Using your right hand, grasp the right headphone.
3. With your left hand, pull up and back on your right ear to straighten your ear canal.
4. Carefully insert your right headphone, rubber eartip first, so that it seals completely and comfortably in your ear. **DO NOT** insert the eartip so deeply that your ear canal feels completely “plugged.”
5. Repeat this procedure for your left ear.
6. When you’ve finished your listening session, remove your in-ear headphones slowly with a twisting motion to gradually break the seal.



Eartip Fit Testing

A good way to gauge whether or not the eartip is sealing properly in your ear canal is by snapping your fingers right next to your ear. If the seal is proper, your ear will not feel “plugged,” yet the snapping of your fingers will sound dull and distant. If you hear your finger snaps distinctly, the seal is probably not adequate. If the sound of your finger snapping is dull and distant, but your ear feels plugged up, like you’re on an airplane preparing to land, then you’ve over-inserted the eartip.

Using iBeats™ on Flights or at High Altitudes

When using iBeats at different altitudes, the air pressure within your ears may change, thereby changing the sound that you hear from the headphones. This is especially true with the gains and drops in altitude during airplane travel. To help with this, occasionally break the eartip seal and re-insert your iBeats headphones into your ears. Another helpful tip is the common exercise of holding your nose and very gently blowing through it, which can relieve some of the pressure in your ears.

Cleaning the Eartips

Keeping your iBeats eartips clean is essential for safe, hygienic use.

IMPORTANT: DO NOT attempt to clean the eartips without first removing them from the headphones. Getting the delicate circuitry inside your iBeats headphones wet may cause permanent damage.

1. Firmly grip the eartip with one hand and the earphone with the other. Carefully remove the eartip from the eartube.
2. Use warm water and mild soap on a damp cloth to remove dirt and earwax from the eartip. **DO NOT** use harsh cleaning agents.
3. Rinse and completely dry your eartips before placing them back on your headphones.
4. Carefully push the eartips back onto the iBeats headphones, making sure they are on the eartube completely.

Talk and Control

iBeats™ has a built-in Monster ControlTalk™ feature for use with music phones and newer iPod.®* The ControlTalk cable has a call answer button and microphone so you can easily switch between listening to music and talking on your phone. It also features music and video playback control for iPod, iPhone® and iPad.™

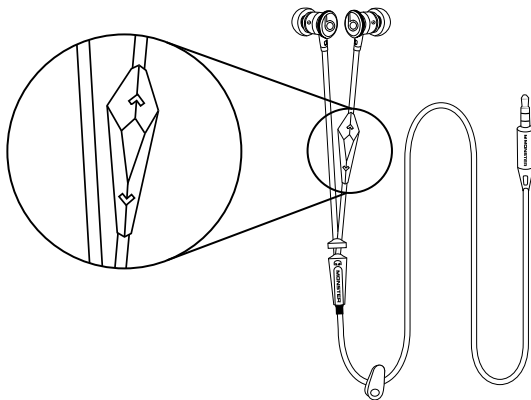

*The remote and mic are supported only by iPod nano® (4th and 5th generation), iPod classic® (120GB, 160GB only), iPod touch® (2nd and 3rd generation), iPhone® 3GS, and iPad.™ The remote is supported by iPod shuffle® (3rd generation). Audio is supported by all iPod® models. Requires latest iPod software. Support for Blackberry® varies by model. Subject to change.

Using ControlTalk™

Answer or end a call: Press and release the center button once to answer. Repeat to end the call.

Decline an incoming call: Press and hold the center button for two seconds, then release. There will be two beeps when you let go to indicate successful operation.

Using call waiting: To switch to an incoming call and put an in-progress call on hold, press and release the center button. Repeat to switch back to the previous call and put the newer call on hold. To switch to an incoming call and end an in-progress call, press and hold the center button for two seconds. You will hear two low beeps when you let go to indicate successful operation.

Play or pause a song or video: Press and release the center button. Repeat to resume.

Skip to the next or previous song or chapter: Press and release the center button twice quickly to skip forward. Press and release three times quickly to skip back.

Scan forward or backward through a song or video: In quick succession, press and release, then press and hold the center button to scan forward. In quick succession, press and release twice, then press and hold the center button to scan backward. Release when you want to stop scanning.

Control volume: Press the (▲) button to increase volume. Press the (▼) button to decrease volume.



Functionality will vary by device.

Manage Cables

Cable Management Clip: Attach the Cable Management Clip to clothing to keep the cable under control and out of your way, as well as reduce accidental pulling of the headphones from your ears.

Cable Slider: Use the Cable Slider to control cable sway while listening. Also slide up to reduce tangles during storage.

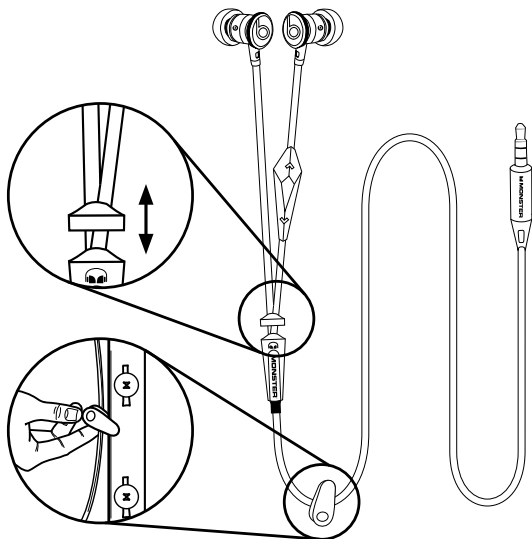

Care and Storage

Keeping iBeats™ headphones clean is essential for safe, hygienic use. Never wear in-ear headphones if they appear dirty.

When not in use, always store your iBeats headphones in the protective case provided.

Keep case closed, and store in a clean, dry environment.

Do not store other items in the case, as this may result in contamination.

Avoid storage in extreme heat or cold.

Avoid exposure to liquids, temperature extremes and high humidity.

! Never pull on the cable to disconnect iBeats headphones from your music player. Grasp the plug at the end of the cable and pull to disconnect.

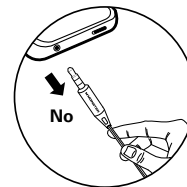
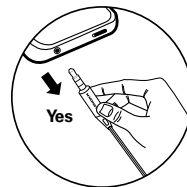

iBeats™ “Break-in”

Break in time for headphones? We’re kidding, right? No we’re not. Like any high performance product, whether it’s cars or headphones, they’re mechanical devices that settle in after use. Your new in-ear headphones will sound incredible out of the box, but will “mellow” out after use and sound even better. We recommend playing them for 8 hours. After 20 hours of playing, they should be fully broken in. Enjoy.

Sound Check

For the best iPod® or iPhone™ listening experience with iBeats, activate iTunes® Sound Check. Sound Check standardizes the volume of all the songs in your music library. iBeats is specially designed to provide a powerful but safe listening experience with Sound Check activated. Learn more about iTunes Sound Check at <http://docs.info.apple.com/article.html?artnum=61655>

LIMITED WARRANTY FOR CONSUMERS

Monster, LLC., 7251 West Lake Mead Blvd., Las Vegas, NV 89128, USA. **(PLEASE NOTE THAT MONSTER DOES NOT ACCEPT PRODUCTS SHIPPED TO THIS ADDRESS – FOLLOW INSTRUCTIONS IN “HOW TO MAKE A CLAIM” BELOW)** (415) 840-2000 (“Monster”) extends You this Limited Warranty. Statutory or common law may provide You with additional rights or remedies, which shall not be affected by this Limited Warranty.

DEFINITIONS

“**Adequate Use**” means use of the Product (i) within a home or dwelling, (ii) for private (as opposed to commercial) purposes, (iii) in conformance with all applicable local, state or federal law, code or regulations (including without limitation building and/or electrical codes), (iv) in accordance with manufacturer recommendations and/or instructions in the materials and documentation that accompany the Product, and (v) if applicable, with proper electrical grounding.

“**Authorized Dealer**” means any distributor, reseller or retailer that (i) was duly authorized to do business in the jurisdiction where it sold the Product to You, (ii) was permitted to sell You the Product under the laws of the jurisdiction where You bought the Product, and (iii) sold You the Product new and in its original packaging.

“**Formal Warranty Claim**” means a claim made in accordance with the section “Formal Warranty Claims” herein.

“**Product**” means a Product (i) that is listed in the Specifications Table below, (ii) that You bought from an Authorized Dealer new and in its original packaging, and (iii) whose serial number, if any, has not been removed, altered, or defaced.

“**Product Defect**” means an inadequacy of the Product that existed at the time when You received the Product from an Authorized Dealer and that causes a failure of the Product to perform in accordance with Monster’s documentation accompanying the Product, unless such failure has been caused completely or partly by (a) any use other than Adequate Use, (b) transportation, neglect, misuse or abuse by anyone other than Monster’s employees; (c) alteration, tampering or modification of the product by anyone other than a Monster employee; (d) accident (other than a malfunction that would otherwise qualify as a Product Defect); (e) maintenance or service of the Product by anyone other than a Monster employee; (f) exposure of the Product to heat, bright light, sun, liquids, sand or other contaminants; or (g) acts outside the control of Monster, including without limitation acts of God, fire, storms, earthquake or flood.

“**Warranty Period**” means the time period during which Monster must have received Your Formal Warranty Claim. The different Warranty Periods related to Product Defects are defined in the Specifications Table below. The Warranty Period commences on the date when You purchased or received (whichever occurs later) the Product from an Authorized Dealer as evidenced by the Authorized Dealer’s invoice, sales receipt or packing slip. If You do not have written proof of the date

of purchase or receipt, then the Warranty Period commences three (3) months after the date when the Product left Monster's or its factory as evidenced by Monster's records. The Warranty Period ends after the time defined in the Specifications Table has expired or after You have transferred ownership of the Product, whichever occurs earlier. Also, You must call Monster and obtain a Return Authorization Number (as described under "How to Make a Claim") within two (2) months after You discover a Product Defect (or should have discovered it, if such Product Defect was obvious).

"You" means the first individual person that purchased the Product in its original packaging from an Authorized Dealer. This Limited Warranty does not apply to persons or entities that bought the Product (i) in used or unpackaged form, (ii) for resale, lease or other commercial use, or (iii) from someone other than an Authorized Dealer.

SCOPE OF THIS LIMITED WARRANTY

PRODUCTS. If a Product contained a Product Defect when You bought it from an Authorized Dealer and Monster receives a Formal Warranty Claim from You within two (2) months after You discover such Product Defect (or should have discovered it, if such Product Defect was obvious) and before the end of the Warranty Period for Product Defects applicable to the affected Product, then Monster will provide You with one of the following remedies: Monster will (1) repair or, at Monster's sole discretion, replace the Product, or (2) refund to You the purchase price You paid to the Authorized Dealer for the affected Product if repair or replacement is not commercially practicable or cannot be timely made. **NOTE: MONSTER DOES NOT ASSUME ANY LIABILITY FOR ANY INCIDENTAL, CONSEQUENTIAL OR INDIRECT DAMAGES UNDER THIS LIMITED WARRANTY.**

GENERAL PROVISIONS

CHOICE OF LAW/JURISDICTION. This Limited Warranty and any disputes arising out of or in connection with this Limited Warranty ("Disputes") shall be governed by the laws of the State of California, USA, excluding conflicts of law principles and excluding the Convention for the International Sale of Goods. The courts located in the State of California, USA shall have exclusive jurisdiction over any Disputes.

OTHER RIGHTS. THIS LIMITED WARRANTY GIVES YOU SPECIFIC LEGAL RIGHTS, AND YOU MAY ALSO HAVE OTHER RIGHTS, WHICH VARY FROM STATE TO STATE AND JURISDICTION TO JURISDICTION, AND WHICH SHALL NOT BE AFFECTED BY THIS LIMITED WARRANTY. THIS WARRANTY EXTENDS ONLY TO YOU AND CANNOT BE TRANSFERRED OR ASSIGNED. If any provision of this Limited Warranty is unlawful, void or unenforceable, that provision shall be deemed severable and shall not affect any remaining provisions. In case of any inconsistency between the English and other versions of this Limited Warranty, the English version shall prevail.

REGISTRATION. Please register Your Product at www.beatsbydre.com/register. Failure to register will not diminish Your warranty rights.

SPECIFICATIONS TABLE

Product Model	Warranty Period for Product
MH IBTS IE BK CT	One (1) year
MH IBTS IE WH CT	One (1) year
MH IBTS IE CR CT	One (1) year
MH IBTS IE BKAL CT	One (1) year

FORMAL WARRANTY CLAIM

HOW TO MAKE A CLAIM. In the event damage has occurred to Products, You must follow these instructions: (1) Call Monster within two (2) months after You discover a Product Defect (or should have discovered it, if such Product Defect was obvious); (2) Give a detailed explanation of how the damage occurred; (3) Obtain a Return Authorization Number; (4) Upon receipt of a claim form (which may be sent to You after You filed Your Formal Warranty Claim), fill out the claim form entirely; (5) Return the Products, shipping prepaid by You (to be refunded if You are entitled to a remedy under the Scope of this Limited Warranty), to Monster for verification of damage, along with a copy of Your original sales receipts and proof of purchase (UPC label or packing slip) for such Products, the completed claim form, and printed Return Authorization Number on the outside of the return package (the claim form will include instructions for return).

TELEPHONE NUMBERS. United States, Asia Pacific and Latin America: 1 877 800-8989 or 415-840-2000, Canada 866-348-4171, Ireland 353 65 68 69 354, Austria 0800-296-482, Belgium 0800-79201, Czech Republic 800-142471, Denmark 8088-2128, Finland 800-112768, France 0800-918201, Germany 0800-1819388, Greece 800-353-12008, Italy 900-982-909, Netherlands 0800-0228919, Norway 800-10906, Russia 810-800-20051353, Spain 900-982-909, Sweden 020-792650, Switzerland 0800-834659, United Kingdom 0800-0569520

FURTHER PROCEEDINGS. Monster will determine whether a Product Defect existed. Monster may, at its discretion, direct You to obtain a repair estimate at a service center. If a repair estimate is required, You will be instructed on how to properly submit the estimate and the resulting invoice to Monster for payment. Any fees for repairs may be negotiated by Monster.

TIMING. If You bring a Formal Warranty Claim and fully comply with all terms and conditions of this Limited Warranty, Monster will use its best efforts to provide You with a remedy within thirty (30) days after receipt of Your Formal Warranty Claim (if You reside in the United States - forty-five (45) days if You reside elsewhere), unless obstacles outside Monster's control delay the process.

Register your Beats™. Today

beatsbydrdre.com/register



©2010 Monster, LLC

"Monster," "ControlTalk," and the product and packaging are trademarks or registered trademarks of Monster Cable Products, Inc. or its subsidiaries in the United States or other countries. "Dr. Dre," "Beats," "iBeats," and the "B logo" are trademarks of Beats Electronics, LLC. iPhone, iPod, iPod classic, iPod nano, iPod shuffle, and iPod touch are trademarks of Apple Inc., registered in the U.S. and other countries. iPad is a trademark of Apple Inc. Apple is not responsible for the operation of this device or its compliance with safety and regulatory standards. BlackBerry is a trademark of Research In Motion Limited.