

# SONY®

3-879-620-11(1)

## Wireless Surround Kit

Operating Instructions\_\_\_\_\_ **US**

Manual de instrucciones\_\_\_\_\_ **ES**

WAHT-SA10

**S-master**  
Digital Amplifier

  
**S-AIR**  
DIGITAL WIRELESS

## Table of Contents

About This Operating Instructions .....	4
Overview .....	4
Unpacking .....	5
Hooking Up .....	6
Connecting the AC Power Cords (Mains Leads) .....	8
Setting up the Wireless System .....	8
Troubleshooting .....	12
Specifications .....	13
Index to Parts .....	15

## WARNING

**To reduce the risk of fire or electric shock, do not expose this apparatus to rain or moisture.**

Do not install the appliance in a confined space, such as a bookcase or built-in cabinet.

To prevent fire or shock hazard, do not place objects filled with liquids, such as vases, on the apparatus.

In door use only.

### **For wireless transceiver (EZW-RT10)**

This transceiver must not be co-located or operated in conjunction with any other antenna or transmitter.

This equipment complies with FCC radiation exposure limits set forth for uncontrolled equipment and meets the FCC radio frequency (RF) Exposure Guidelines in Supplement C to OET65. This equipment should be installed and operated with at least 20 cm and more between the radiator and person's body (excluding extremities: hands, wrists, feet and ankles).

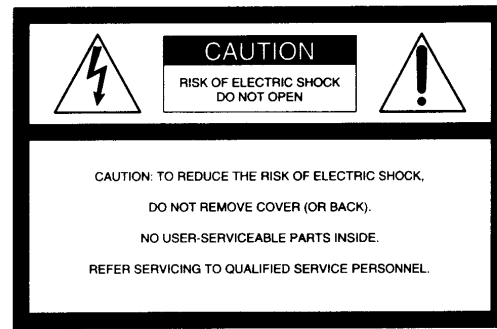

This symbol is intended to alert the user to the presence of uninsulated "dangerous voltage" within the product's enclosure that may be of sufficient magnitude to constitute a risk of electric shock to persons.



This symbol is intended to alert the user to the presence of important operating and maintenance (servicing) instructions in the literature accompanying the appliance.

### **Owner's Record**

The model and serial numbers are located on the side exterior of the unit. Record the serial number in the space provided below. Refer to them whenever you call upon your Sony dealer regarding this product.

Model No. WAHT-SA10

Serial No. \_\_\_\_\_

Date of Manufacture Marking, Shock Hazard Marking and Associated Graphical Symbols are located on the bottom exterior.

The following FCC statement applies only to the version of this model manufactured for sale in the USA. Other versions may not comply with FCC technical regulations.

## WARNING

This equipment has been tested and found to comply with the limits for a Class B digital device, pursuant to Part 15 of the FCC Rules. These limits are designed to provide reasonable protection against harmful interference in a residential installation. This equipment generates, uses, and can radiate radio frequency energy and, if not installed and used in accordance with the instructions, may cause harmful interference to radio communications. However, there is no guarantee that interference will not occur in a particular installation. If this equipment does cause harmful interference to radio or television

reception, which can be determined by turning the equipment off and on, the user is encouraged to try to correct the interference by one or more of the following measures:

- Reorient or relocate the receiving antenna.
- Increase the separation between the equipment and receiver.
- Connect the equipment into an outlet on a circuit different from that to which the receiver is connected.
- Consult the dealer or an experienced radio/TV technician for help.

## CAUTION

You are cautioned that any changes or modifications not expressly approved in this manual could void your authority to operate this equipment.

## Important Safety Instructions

- 1) Read these instructions.
- 2) Keep these instructions.
- 3) Heed all warnings.
- 4) Follow all instructions.
- 5) Do not use this apparatus near water.
- 6) Clean only with dry cloth.
- 7) Do not block any ventilation openings. Install in accordance with the manufacturer's instructions.
- 8) Do not install near any heat sources such as radiators, heat registers, stoves, or other apparatus (including amplifiers) that produce heat.
- 9) Do not defeat the safety purpose of the polarized or grounding-type plug. A polarized plug has two blades with one wider than the other. A grounding type plug has two blades and a third grounding prong. The wide blade or the third prong are provided for your safety. If the provided plug does not fit into your outlet, consult an electrician for replacement of the obsolete outlet.
- 10) Protect the power cord from being walked on or pinched particularly at plugs, convenience receptacles, and the point where they exit from the apparatus.
- 11) Only use attachments/accessories specified by the manufacturer.

- 12) Use only with the cart, stand, tripod, bracket, or table specified by the manufacturer, or sold with the apparatus. When a cart is used, use caution when moving the cart/apparatus combination to avoid injury from tip-over.



- 13) Unplug this apparatus during lightning storms or when unused for long periods of time.
- 14) Refer all servicing to qualified service personnel. Servicing is required when the apparatus has been damaged in any way, such as power-supply cord or plug is damaged, liquid has been spilled or objects have fallen into the apparatus, the apparatus has been exposed to rain or moisture, does not operate normally, or has been dropped.

## Precautions

### On power sources

Install this system so that the AC power cord (mains lead) can be unplugged from the wall outlet (mains) immediately in the event of trouble.

### On placement

- Do not place the system in locations that are hot and subject to direct sunlight, dusty, very humid, or extremely cold.
- Use caution when placing the system on a specially treated (waxed, oiled, polished, etc.) floor, as staining or discoloration may result.
- Allow adequate air circulation to prevent internal heat buildup.
- Do not place the system on surfaces (rugs, blankets, etc.) or near materials (curtains, draperies) that may block the ventilation slots.
- Do not install the system near heat sources such as radiators or air ducts, or in a place subject to direct sunlight, excessive dust, mechanical vibration or shock.
- Do not install the system in an inclined position. It is designed to be operated in a horizontal position only.
- Keep the system away from equipment with strong magnets, such as microwave ovens, or large loudspeakers.
- Do not place heavy objects on the system.
- If you use more than one set of S-AIR products, position them away from each other to avoid cross talk.
- Install this surround amplifier and S-AIR products at least 50 cm away from people.

US

- To prevent fire or shock hazard, do not place objects filled with liquids, such as vases, on the apparatus.
- Do not place the system on carpet, as discoloration may result.
- If you use more than one surround amplifier, do not place one on top of the other.

### On cleaning

Clean the cabinets only with a soft dry cloth. Do not use any type of abrasive pad, scouring powder or solvent such as alcohol or benzene.

### Safety

- If anything falls into the cabinet, unplug the unit and have it checked by qualified personnel before operating it any further.
- Unplug the unit from the wall outlet (mains) if you do not intend to use it for an extended period of time. To disconnect the cord, pull it out by the plug, never by the cord.

## About This Operating Instructions

WAHT-SA10 is a surround amplifier for Sony S-AIR products. The amplifier is for models that have an “EZW-RT10” or “EZW-T100” slot on their rear panel.

## Overview

This surround amplifier allows you to use a 5.1 channel system (five speakers and one subwoofer) or 7.1 channel system (seven speakers and one subwoofer).

## Enjoying a 5.1 channel system

S-AIR can avoid cluttered cords to keep your room tidy.

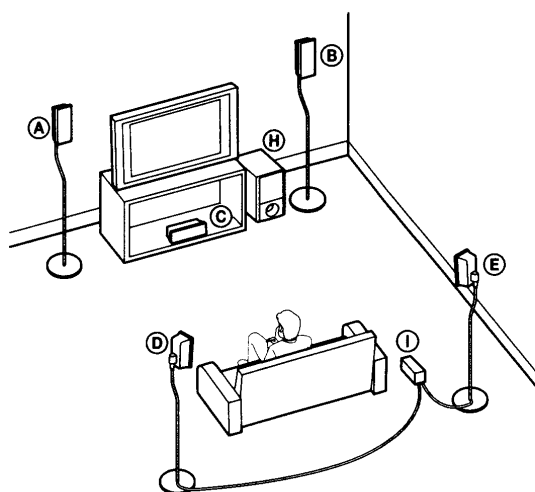

## Enjoying a 7.1 channel system

S-AIR makes possible a 7.1 channel system, using two surround and two surround back speakers.

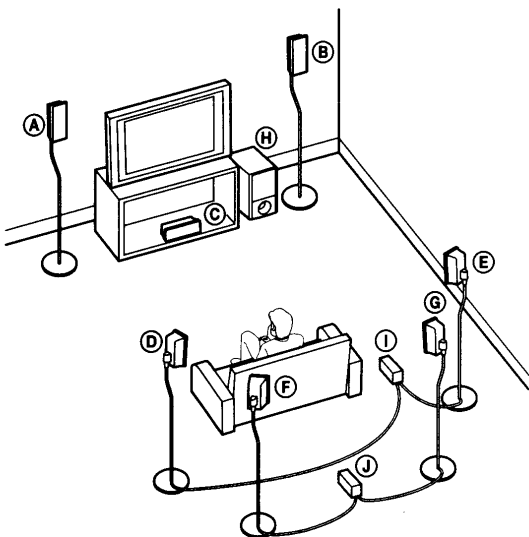

- Ⓐ Front left speaker
- Ⓑ Front right speaker
- Ⓒ Center speaker
- Ⓓ Surround left speaker
- Ⓔ Surround right speaker
- Ⓕ Surround back left speaker
- Ⓖ Surround back right speaker
- Ⓗ Subwoofer
- Ⓘ Surround amplifier  
(for surround speakers)
- ⓵ Surround amplifier  
(for surround back speakers)

## Unpacking

### Surround amplifier TA-SA100WR (1)

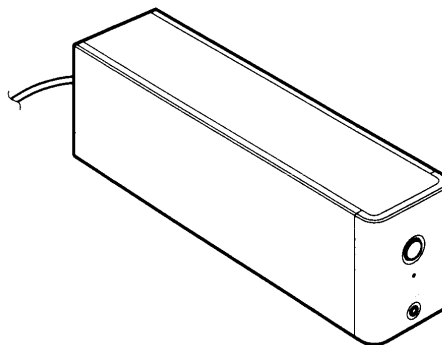

### Speaker cord cover (1)

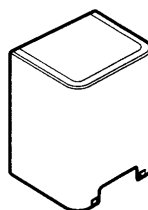

### Speaker cord holder (1)

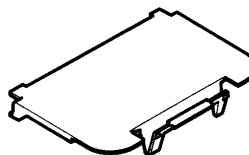

### Wireless adapter

Wireless transceiver (EZW-RT10) (1)

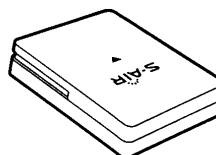

### Speaker cords (2)



### Operating Instructions (1)

## Hooking Up

Connect the surround amplifier to your S-AIR main unit.

**Before installing, make sure to remove the AC power cords (mains leads) of all S-AIR products from wall outlets (mains).**

## Inserting wireless adapters

- 1** Insert the wireless transceiver (supplied) in the slot on the rear of the surround amplifier.

### Note

- Insert the wireless transceiver (supplied) with the S-AIR logo facing up. Also, make sure the ▼ marks on the wireless transceiver (supplied) and the slot on the surround amplifier are aligned when inserting.
- Do not touch the terminal of the wireless adapter.

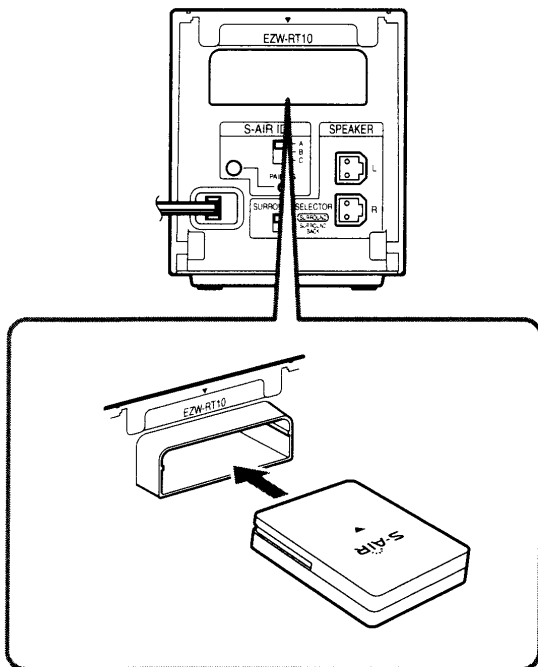

- 2** Insert the wireless adapter (not supplied) in the slot on the S-AIR main unit.

If a wireless adapter is not supplied with your S-AIR main unit, you can purchase a wireless transmitter EZW-T100.

For details, refer to the operating instructions of the S-AIR main unit.

### Note

- Insert the wireless adapter (not supplied) with the S-AIR logo facing up. Also, make sure the ▼ marks on the wireless adapter (not supplied) and the slot on the S-AIR main unit are aligned when inserting.
- Do not touch the terminal of the wireless adapter.

The illustration of the rear panel of an S-AIR main unit is an example. Not all S-AIR main units look exactly the same.

Rear panel

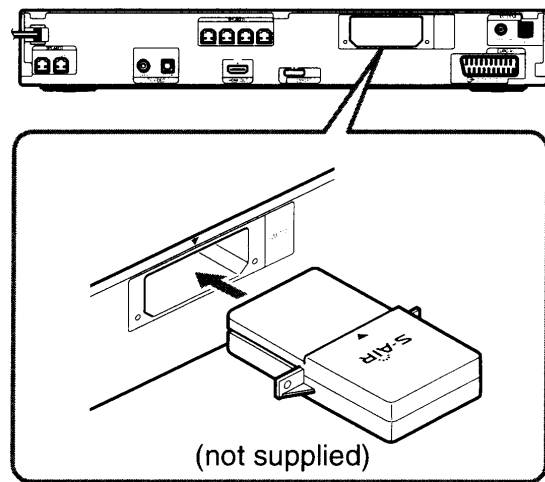

## Connecting the speakers

Insert the connectors of the speaker cords (supplied) into their corresponding speaker jacks. The connectors of the speaker cords are the same color as their corresponding jacks. The speakers shown are for illustration purposes only. Not all the speakers are identical.

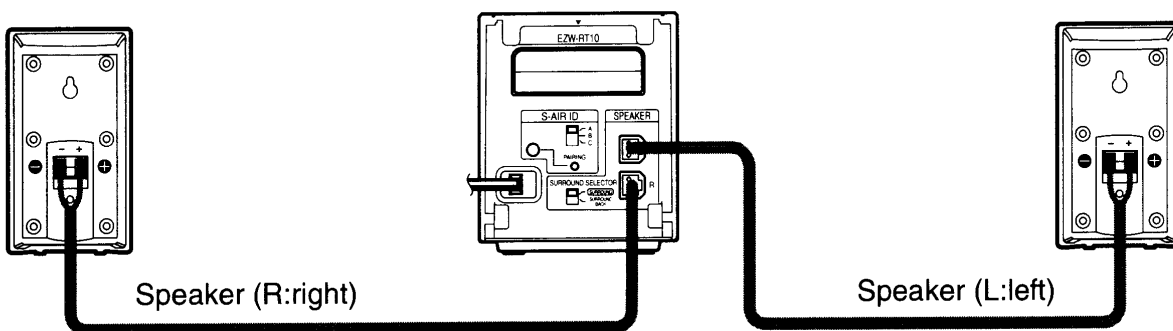

The connector and color tube of the speaker cords are the same color as the label of their corresponding jacks. Be sure to match the speaker cords to the appropriate terminals on the speakers: the speaker cord with the color tube to  $\oplus$ , and the speaker cord without the color tube to  $\ominus$ . Do not catch the speaker cord insulation in the speaker terminals.

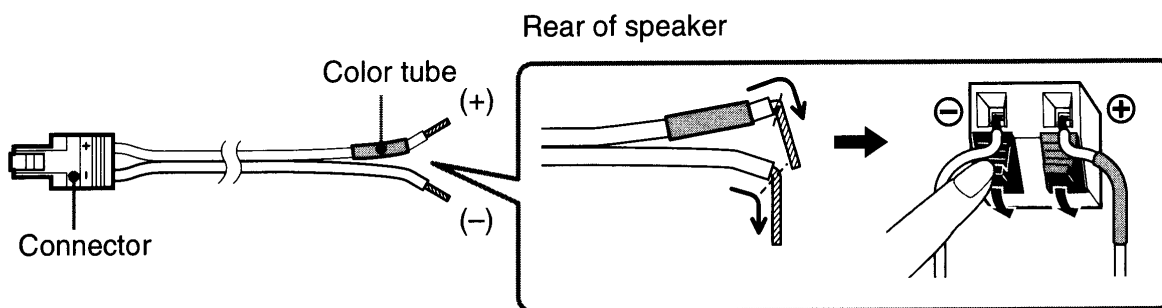

When connecting to the surround amplifier, insert the connector until it clicks.

### Note

- When you use this wireless surround kit, do not connect the speaker cord(s) to the surround speaker jack(s) on your Sony Home Theatre System (DAV).

## Connecting the AC Power Cords (Mains Leads)

Before connecting the AC power cords (mains leads) of your S-AIR main unit and the surround amplifier to wall outlets (mains), make sure that all speakers are connected.

## Setting up the Wireless System

To use the wireless system, you need to set up the surround amplifier and your S-AIR main unit. Before setting, make sure that the wireless adapters are correctly inserted in the S-AIR main unit and surround amplifier.

### Front panel

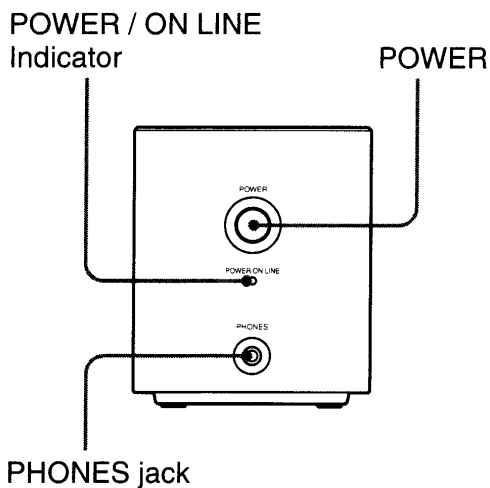

### Rear panel

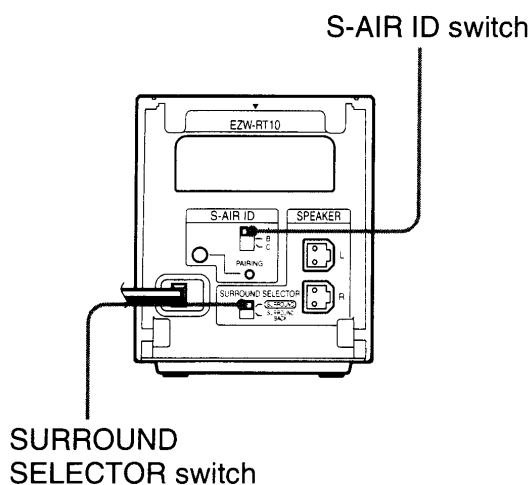

## ID setting

By matching the ID of the surround amplifier and your S-AIR main unit, you can establish sound transmission. You can also use multiple S-AIR products by setting a different ID for each product.

## Setting up the S-AIR main unit

- 1 Turn on the S-AIR main unit.  
The system turns on.
- 2 Set up the S-AIR main unit so it is ready for ID setting.
- 3 Select the ID for the S-AIR main unit.

You can select any ID (A, B, or C). For details, refer to the operating instructions of the S-AIR main unit.

## Setting up the surround amplifier

- 1 Set the SURROUND SELECTOR switch (SURROUND or SURROUND BACK) of the surround amplifier to match the S-AIR main unit.
- 2 Set the S-AIR ID switch of the surround amplifier to match the ID (A, B, or C) of the S-AIR main unit.



### 3 Press **POWER** on the surround amplifier.

The **POWER / ON LINE** indicator turns green. If not, see “Checking the transmission status” (page 9).

### 4 Set up the speakers.

If the S-AIR main unit has the Auto Calibration function, perform Auto Calibration. If the S-AIR main unit does not have the Auto Calibration function, perform the appropriate speaker setting. For details, refer to the operating instructions of the S-AIR main unit.

---

## Checking the transmission status

You can check the status of sound transmission between the S-AIR main unit and surround amplifier by checking the **POWER / ON LINE** indicator on the surround amplifier.

<b>POWER / ON LINE indicator</b>	<b>Status</b>
Turns green	Sound transmission is established.
Flashes green	Sound transmission is not established. For details, see “Troubleshooting” (page 12).
Turns red	The surround amplifier does not output sound. For details, see “Troubleshooting” (page 12).
Turns off	The surround amplifier turns off or its protection is active. For details, see “Troubleshooting” (page 12).

---

## Enjoying the sound by using headphones

You can enjoy the system’s sound in a place away from the S-AIR main unit by connecting the headphones to the **PHONES** jack on the surround amplifier.

### Note

- When you connect headphones to the surround amplifier, neither the surround amplifier nor the S-AIR main unit outputs sound from the system’s speakers.
- The volume of the S-AIR main unit is minimized if you turn off the surround amplifier with headphones connected, or radio reception is poor. In either case, check radio reception, and set the volume again.

## Preventing transmission to neighbors (Pairing)

If your neighbors also have S-AIR products and their IDs are the same as yours, your neighbors could receive the sound of your S-AIR main unit. To prevent this, you can identify your S-AIR products by performing the pairing operation.

### ■ Before the pairing operation (example)

The sound transmission is established by the ID.

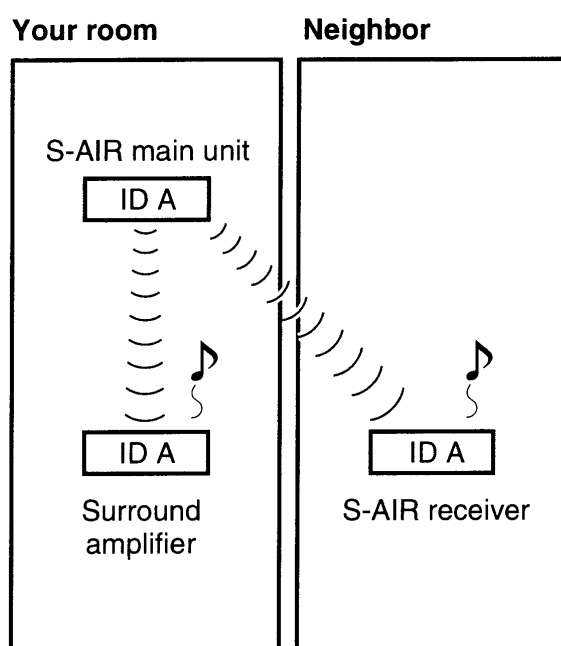

### ■ After the pairing operation (example)

Sound transmission is established between the surround amplifier and the S-AIR main unit that performed the pairing operation.

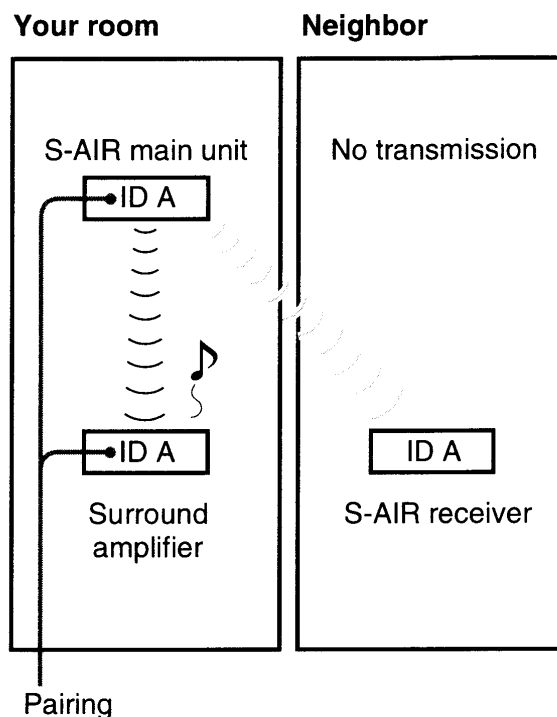

- 1 Turn on the S-AIR main unit and the surround amplifier.**  
The system turns on.
- 2 Match the IDs of the S-AIR main unit and the surround amplifier.**
- 3 Set up the S-AIR main unit so it is ready for pairing.**

For details, refer to the operating instructions of the S-AIR main unit. The POWER / ON LINE indicator on the surround amplifier flashes green.

- 4 Press PAIRING on the rear panel of the surround amplifier.**

The PAIRING indicator flashes red when pairing starts.

When sound transmission is established, the POWER / ON LINE indicator turns green and the PAIRING indicator turns on.

If you use more than one surround amplifier, perform Steps 3 and 4 for those also.

**Note**

- If you perform the pairing operation between the surround amplifier and another S-AIR main unit, sound transmission established by the ID is canceled.
- Pairing will not be canceled unless you change the ID setting.

**Tip**

- To press the PAIRING button, a slim instrument, such as a paper clip, can be used.

## Attaching the cover to the surround amplifier

After connecting, you can attach the cover to the surround amplifier to organize and store excess speaker cords.

- 1 Attach the speaker cord cover by sliding it down along the grooves on the edges of the surround amplifier.**

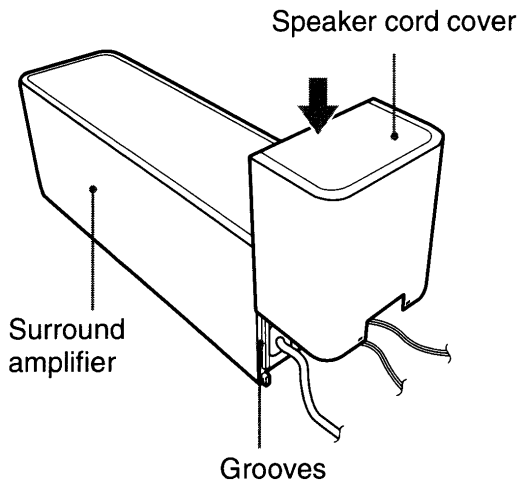

Push the speaker cord cover down until you hear a click. Turn the surround amplifier upside down, and store the cords in the speaker cord cover.

- 2 Insert the tabs of the speaker cord holder in the slots of the speaker cord cover, and press it into place.**

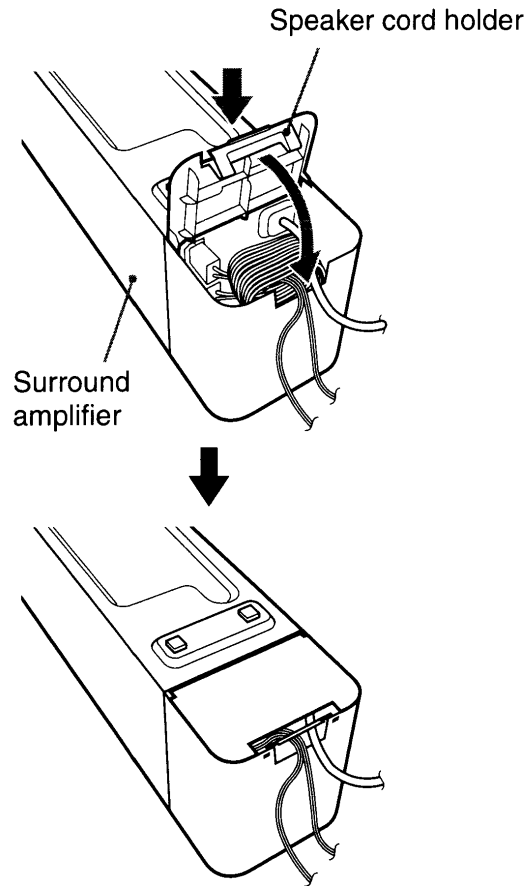
**Note**

- When detaching, remove the speaker cord holder, then remove the speaker cord cover. To remove the speaker cord holder, slightly press the catch of the holder and lift off. To remove the speaker cord cover, slightly splay open the edges of the cover and slide down.
- Do not use excessive force to store the cords.

# Troubleshooting

If you experience any of the following difficulties while using the system, use this troubleshooting guide to help remedy the problem before requesting repairs. Should any problem persist, consult your nearest Sony dealer.

Note that if service personnel changes some parts during repair, these parts may be retained.

In the event of a problem with the surround amplifier, have a Sony dealer check the entire system together (system, speakers, and wireless adapters).

## Power

### The power is not turned on.

- Check that the AC power cord (mains lead) is connected securely.

### The POWER / ON LINE indicator does not turn on.

Turn off the surround amplifier and remove the AC power cord (mains lead) of the surround amplifier, then check the following items.

- Are the + and – speaker cords short-circuited?
- Is anything blocking the ventilation holes of the surround amplifier?
- After checking the above items and fixing any problems, connect the AC power cord (mains lead) of the surround amplifier and turn on. If the cause of the problem cannot be found even after checking all the above items, consult your nearest Sony dealer.

## Sound

### There is no sound.

Check the status of the POWER / ON LINE indicator on the surround amplifier.

- turns green
  - The speaker cord is not connected securely.
  - Check the speaker connections and settings.
  - The volume of the S-AIR main unit is set to minimum.
  - The S-AIR main unit is in mute status.
  - Depending on the source or the settings of the S-AIR main unit, the effect of the speakers may be less noticeable.
  - Headphones are connected.
- flashes green

- The S-AIR main unit is not turned on.
- The S-AIR main unit is paired to another S-AIR product.
- The surround amplifier is paired to another S-AIR main unit.
- Confirm the IDs of the S-AIR main unit and surround amplifier (page 8).
- Pairing operation is not completed.
- Sound transmission is poor. Move the surround amplifier so that the POWER / ON LINE indicator turns green.
- Move the system away from any other wireless products.
- Stop using another wireless product.
- The wireless adapter is not inserted correctly.
- turns red
  - Change the SURROUND SELECTOR switch (SURROUND or SURROUND BACK) of the surround amplifier to match the S-AIR main unit.

### No sound is heard from the S-AIR main unit.

- Volume becomes the minimum when you turn off the surround amplifier with headphones connected before you turn off the S-AIR main unit or if radio reception is poor. In these cases, check radio reception, and set the volume again.

### Severe hum or noise is heard.

- Check that the S-AIR products are connected securely.
- Check that the connecting cords are away from a transformer or motor, and at least 3 meters (10 ft) away from your TV set or a fluorescent light.
- Move your TV away from the audio components.
- The plugs and jacks are dirty. Wipe them with a cloth slightly moistened with alcohol.
- Clean the disc.

### No sound or only a very low-level sound is heard from the speakers.

- Check the speaker connections and settings.
- Check the decoding mode setting.
- Depending on the source, the effect of the speakers may be less noticeable.
- Wireless setting of the speaker is not correct.
- A 2 channel source is being played.

### No sound is heard or sound is cut off.

- The S-AIR main unit and/or the surround amplifier is installed in a place such as on a metal shelf.
- Wireless LANs, a microwave (oven) and Bluetooth applications, etc. are placed near the surround amplifier.

- Move away the other components from the surround amplifier or turn off the other components.

## Operation

### The system does not work normally.

- Disconnect the AC power cord (mains lead) from the wall outlet (mains), then reconnect after several minutes.

## Specifications

### TA-SA100WR (Surround amplifier)

### AUDIO POWER SPECIFICATIONS for the US model

#### POWER OUTPUT AND TOTAL HARMONIC DISTORTION:

With 3 ohm loads,  
both channels  
driven, from 120 -  
20,000 Hz; rated 50  
watts per channel  
minimum RMS  
power, with no  
more than 0.7 %  
total harmonic  
distortion from 250  
milliwatts to rated  
output.

### Amplifier section

US models:

Surround mode (reference) RMS output power  
143W (per channel  
at 3 ohms, 1 kHz,  
10 % THD)

Other models:

Stereo mode (rated) 80 W + 80 W (at  
3 ohms, 1 kHz, 1 %  
THD)

Surround mode (reference) RMS output power  
143 W (per channel  
at 3 ohms, 1 kHz,  
10 % THD)

*\* Depending on the source, there may be no  
sound output.*

Rated impedance: 3 - 16  $\Omega$

## General

Power requirements	120 V AC, 60 Hz
Power consumption	On: 50 W
Dimensions (approx.)	85 mm × 100 mm × 330 mm (3 <sup>3</sup> / <sub>8</sub> in × 4 in × 13 in) (w/h/d) (incl. EZW-RT10)
	85 mm × 100 mm × 345 mm (3 <sup>3</sup> / <sub>8</sub> in × 4 in × 13 <sup>5</sup> / <sub>8</sub> in) (w/h/d) incl. speaker cord cover and speaker cord holder
Mass (approx.)	1.7 kg (3 lb 12 oz) incl. speaker cord cover and speaker cord holder

## EZW-RT10

Communication System	S-AIR Specification version 1.0
Output	12.0 mW
Frequency band	2.4000 GHz - 2.4835 GHz
Modulation method	DSSS
Power requirements	DC 3.3 V, 350 mA
Dimensions (approx.)	50 mm × 13 mm × 60 mm (2 in × 17/32 in × 2 <sup>3</sup> / <sub>8</sub> in) (w/h/d)
Mass (approx.)	24g (1 oz)

Design and specifications are subject to change without notice.

“S-AIR” and its logo are trademarks of Sony Corporation.



- Halogenated flame retardants are not used in the printed wiring boards.
- Over 85 % power efficiency of amplifier block is achieved with the full digital amplifier, S-master.
- Packaging cushions are made of paper.

## Surround amplifier

**Front panel**

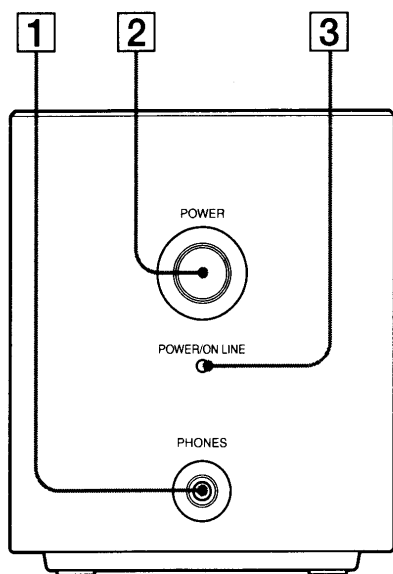

**Rear panel**

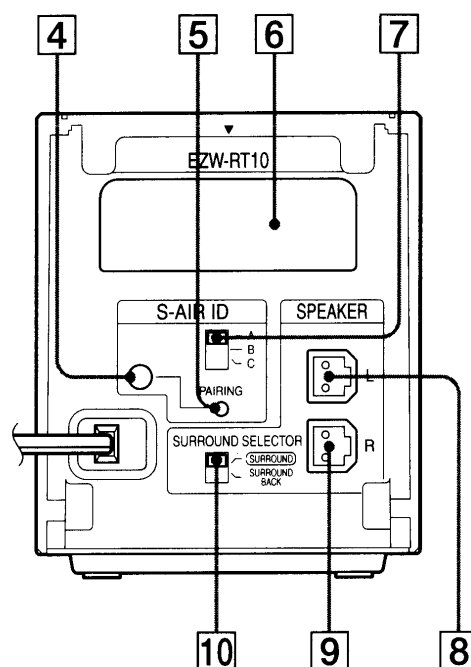

- 1 PHONES jack**
- 2 POWER button (ON/OFF)**
- 3 POWER / ON LINE indicator**
- 4 PAIRING indicator**
- 5 PAIRING button**
- 6 Wireless transceiver (EZW-RT10) slot**
- 7 S-AIR ID switch**
- 8 SPEAKER L jack**
- 9 SPEAKER R jack**
- 10 SURROUND SELECTOR switch**



\* 3 8 7 9 6 2 0 1 1 \* (1)



Thank you for purchasing this Sony product. Proper registration will enable us to send you periodic mailings about new products and other important announcements. Registering your product will also allow us to contact you in the unlikely event that it will need adjustment or modification. Please take the time to register your new product at our website:

**<http://www.sony.com/productregistration>**

You will find the product serial number on the main unit and the carton box.

If you have any operational questions regarding your new purchase, please contact your retailer. For the location of a Sony dealer in your area, or for any other questions, please call 1-800-222-SONY(7669).

Thank you.

**SONY®**General Stereo/Hifi Components/Tape Decks  
CD Players/Mini Disc Players/Audio Systems

Hifi Audio

# LIMITED WARRANTY (U.S. Only)

Sony Electronics Inc. ("Sony") warrants this product against defects in material or workmanship for the time periods and as set forth below. Pursuant to this Limited Warranty, Sony will, at its option, (i) repair the product using new or refurbished parts or (ii) replace the product with a new or refurbished product. For purposes of this Limited Warranty, "refurbished" means a product or part that has been returned to its original specifications. **In the event of a defect, these are your exclusive remedies.**

**Labor:** For a period of one (1) year from the original date of purchase of the product ("Labor Warranty"), Sony will, at its option, repair or replace with new or refurbished product, product determined to be defective. If Sony elects to replace the product after this Labor Warranty has expired but while the Parts Warranty below is still in effect, it will do so for the applicable labor charge.

**Parts:** For a period of one (1) year from the original date of purchase of product ("Parts Warranty"), Sony will supply new or refurbished replacement parts in exchange for parts determined to be defective.

This Limited Warranty covers only the hardware components packaged with the Product. It does not cover technical assistance for hardware or software usage and it does not cover any software products whether or not contained in the Product; any such software is provided "AS IS" unless expressly provided for in any enclosed software Limited Warranty. Please refer to the End User License Agreements included with the Product for your rights and obligations with respect to the software.

**Instructions:** To obtain warranty service, you must deliver the product, freight prepaid, in either its original packaging or packaging affording an equal degree of protection to the Sony authorized service facility specified. **It is your responsibility to backup any data, software or other materials you may have stored or preserved on your unit. It is likely that such data, software, or other materials will be lost or reformatted during service and Sony will not be responsible for any such damage or loss.** A dated purchase receipt is required. For specific instructions on how to obtain warranty service for your product,

Visit Sony's Web Site:  
[www.sony.com/service](http://www.sony.com/service)

Or call the **Sony Customer Information Service Center**  
**1-800-222-SONY (7669)**

For an accessory or part not available from your authorized dealer, call:

1-800-488-SONY (7669)

**Repair / Replacement Warranty:** This Limited Warranty shall apply to any repair, replacement part or replacement product for the remainder of the original Limited Warranty period or for ninety (90) days, whichever is longer. Any parts or product replaced under this Limited Warranty will become the property of Sony.

This Limited Warranty only covers product issues caused by defects in material or workmanship during ordinary consumer use; it does not cover product issues caused by any other reason, including but not limited to product issues due to commercial use, acts of God, misuse, limitations of technology, or modification of or to any part of the Sony product. This Limited Warranty does not cover Sony products sold AS IS or WITH ALL FAULTS or consumables (such as fuses or batteries). This Limited Warranty is invalid if the factory-applied serial number has been altered or removed from the product. This Limited Warranty is valid only in the United States.

**LIMITATION ON DAMAGES:** SONY SHALL NOT BE LIABLE FOR ANY INCIDENTAL OR CONSEQUENTIAL DAMAGES FOR BREACH OF ANY EXPRESS OR IMPLIED WARRANTY ON THIS PRODUCT.

**DURATION OF IMPLIED WARRANTIES:** EXCEPT TO THE EXTENT PROHIBITED BY APPLICABLE LAW, ANY IMPLIED WARRANTY OF MERCHANTABILITY OR FITNESS FOR A PARTICULAR PURPOSE ON THIS PRODUCT IS LIMITED IN DURATION TO THE DURATION OF THIS WARRANTY.

Some states do not allow the exclusion or limitation of incidental or consequential damages, or allow limitations on how long an implied warranty lasts, so the above limitations or exclusions may not apply to you. This Limited Warranty gives you specific legal rights and you may have other rights which vary from state to state.